

**THE UNITED REPUBLIC OF TANZANIA  
MINISTRY OF HEALTH, COMMUNITY  
DEVELOPMENT, GENDER, ELDERLY AND CHILDREN**



**PROPOSED CONSTRUCTION OF A BUILDING FOR  
EMERGENCY MEDICAL DEPARTMENT (EMD) BLOCK  
AT SINGIDA REGIONAL REFERRAL HOSPITAL -  
MANDEWA**

**TENDER No. ME/007/SRRH/2021/2022/W/2**

**BETWEEN**

**MEDICAL OFFICER INCHARGE  
P .O. Box 104 – SINGIDA  
(The Employer)**

**AND**

**M/S LUBA CONTRACTORS CO. LTD  
P .O. BOX 38264  
DAR ES SALAAM  
(The contractor)**

**DECEMBER, 2021**

# FORM OF AGREEMENT

fm

## FORM OF AGREEMENT

THIS CONTRACT AGREEMENT, is made the 6<sup>th</sup> day of **Deesember, 2021** between **Medical Officer Icharge of P .O. Box 104, Singida** (Hereinafter called "the Employer") on the other part and **M/S Luba Contractors Co. Ltd of P.O. Box 38264, Dar es Salaam** (hereinafter called "the Contractor") on the other part.

Whereas the Employer is desirous that certain works should be carried out, viz:

**Proposed Construction of Emergency Medical Department ( EMD ) at Singida Regional Referral Hospital** located at **Singida Municipality** and has by the letter of Acceptance **Ref. No. LCC/V.02/SGD/2021/08** dated **04<sup>th</sup> December, 2021** accepted a Tender by the Contractor for execution, and completion of such Works.

### NOW THIS AGREEMENT WITNESSETH AS FOLLOWS:

1. In this Agreement words and expressions shall have the same meanings as are respectively assigned to them in the Conditions of Contract hereinafter referred to and;
2. The following documents shall be deemed to form and be read and construed as part of this Agreement, viz: -
  1. Form of Agreement;
  2. Letter of Acceptance;
  3. Quotation Submission Form
  4. Contract Data
  5. General Conditions of Contract
  6. Specifications
  7. Drawings
  8. Priced Bill of Quantities
  9. Any other document forming part of the contract (Minutes of clarifications, anti-bribery memorandum)
3. All the aforesaid documents are hereinafter referred to as 'the Contract' and shall be taken as complementary and mutually explanatory of one another but in case of ambiguities or discrepancies shall take precedence in the order set out above.

4. In consideration of the payments to be made by the Employer to the Contractor as hereinafter mentioned, the Contractor hereby covenants with the Employer to execute and complete the works in conformity, in all respects, with the provisions of the Contract.
5. The Employer hereby covenants to pay the Contractor in consideration of the execution and completion of the works, the sum of Tanzanian Shillings **Seven Hundred Sixty Six million Seventeen Thousand Eight Hundred Sixty Three and Fifty Two Cents. (T.shs 766,017,863.52)** VAT inclusive for Proposed Construction of a Building for Emergency Medical Department (EMD) Block period of 180 days, hereinafter referred to as the "Contract Price", at the times and in the manner prescribed by the Contract.

IN WITNESS where of, the parties hereto have set their hands and seals on the day and year first above written.

**SIGNED FOR AND ON BEHALF OF THE EMPLOYER**

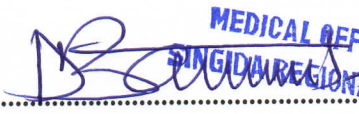
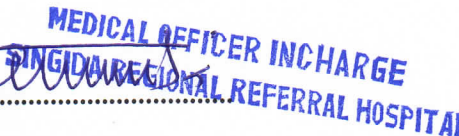
  
  
 Signature  
 (Name) DR. D. FOGARINAS G. BANNUBA  
 (Occupation) MEDICAL OFFICER IN CHARGE  
 (Address) P.O. BOX 104 SINGIDA  
 (Date) 6/12/2021

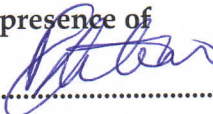
In the presence of  
  
 Signature  
 (Name) Emmanuel K. Lewo  
 (Occupation) RHS - SINGIDA  
 (Address) P.O. BOX 5 - SINGIDA  
 (Date) 6/12/2021

**ON BEHALF OF THE CONTRACTOR:**

  
 Signature  
 (Name) MR. JOSEPH MAGIDA  
 (Occupation) CONTRACT DIRECTOR  
 (Address) P.O. BOX 38260, D'SALAAM  
 (Date) 06<sup>TH</sup> DECEMBER 2021

In the presence of  
  
 Signature  
 (Name) ELBARIKI F. IDABU  
 (Occupation) Logistics Manager  
 (Address) P.O. BOX 38260, D'SALAAM  
 (Date) 06<sup>TH</sup> DECEMBER 2021



*fn*

# LETTER OF ACCEPTANCE

*fm*



# LUBA CONTRACTORS CO. LTD.

Dealers in: Building & Civil Engineering works, Well Drilling, Supplies of Building Materials, consultancy Plot No. 731; Block 5, Tabata P.O.Box 38264 Dar es Salaam, Branch -Street Uhuru, Kisasa, Dodoma-Tanzania Mob: +255 (0) 684 291745+255 (0) 742 493 927 E-mail: info@luba.co.tz website: www.luba.co.tz

Our Ref: LCC/ V.02/SGD/2021/08

Date: 04<sup>th</sup> December, 2021

To:

Medical Officer In charge,  
Singida Regional Referral Hospital,  
P.o.Box 104,  
**SINGIDA**

Dear Sir,

**RE: PROPOSED CONSTRUCTION OF EMEGENCY MEDICAL DEPARTMENT  
(EMD) BLOCK AT SINGIDA REGIONAL REFERRAL HOSPITAL FOR TENDER  
NO.ME/007/SRRH/2021/2022/W/02**

**SUB: Acceptance Letter of Notification of Award.**

We, Luba Contractors Company Limited hereby writing with response to your notification letter of tender award with Ref.No.SRRH/E.51/01/68 dated on 03<sup>rd</sup> December, 2021 sub-captioned above.

With this letter we are truly humbled to accept this award of Proposed Construction of Emergency Medical Department (EMD) Tender No.ME/007/SRRH/2021/2022/W/2 for the Contract Price of **TZS.766, 017,863.52 [Tanzania Shillings Seven Hundred Sixty Six Million Seventeen Thousand Eight Hundred Sixty Three and Fifty Two cents Only] VAT Inclusive.**

Therefore, we take this opportunity to thank your Organization for choosing working with us, our technical team is ready to commence the execution of the project as sooner as contract is signed for a given period of 180 days.

Meanwhile, this letter replaces our letter with Ref.No.LCC/V.02/SGD/2021/08 dated on 04<sup>th</sup> December, 2021.

Yours Sincerely,

  
Arch. Joseph Magida,  
For: Managing Director

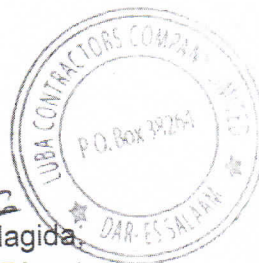

*fm*

# TENDER SUBMISSION FORM



# LUBA CONTRACTORS CO. LTD.

Dealers in: Building & Civil Engineering works, Well Drilling, Supplies of Building Materials, consultancy Plot No. 731; Block 5, Tabata P.O.Box 38264 Dar es Salaam, Branch -Street Uhuru, Kikasa,Dodoma-Tanzania Mob: +255 (0) 684 291745+255 (0) 742 493 927 E-mail: info@luba.co.tz website: www.luba.co.tz

Our Ref: LCC/V.02/SGD/2021/04

Date: 15<sup>th</sup> November, 2021

To:

Medical Officer In charge,  
Singida Regional Referral Hospital,  
P.o.Box 104,  
SINGIDA

Dear Sir,

**RE: PROPOSED CONSTRUCTION OF EMERGENCY MEDICAL DEPARTMENT (EMD) AND ICU BLOCK AT SINGIDA REGIONAL REFERRAL HOSPITAL FOR TENDER NO.ME/007/SRRH/2021/2022/W/2.**

**SUB: SUBMISSION COST FOR PROPOSED CONSTRUCTION OF MEDICAL EMERGENCY DEPARTMENT (EMD) BLOCK.**

Reference is made to the heading above.

We,Luba Contractors Company Limited hereby submit the cost amounting to TZS.766,017,863.52/Tanzania Shillings Seven Hundred Sixty Six Million Seventeen Thousand Eight Hundred Sixty Three and Fifty Two Cents Only/ VAT Inclusive for Proposed Construction of Emergency Medical Department (EMD) at Singida Referrah Hospital.

We offer to execute the work for in a period of **180** Calendars of days (**Six Months**) from the date of commencement.

Yours sincerely,



*Joseph Magida*  
Arch. Joseph Magida,  
For: Managing Director



**SPECIAL CONDITION OF THE  
CONTRACT**

*h*

**SECTION IV: SPECIAL CONDITIONS OF CONTRACT**

*fu*

## Special Conditions of Contract (SCC)

The following Special Conditions of Contract shall supplement the General Conditions of Contract. Whenever there is a conflict, the provisions herein shall prevail over those in the General Conditions of Contract. Except where otherwise indicated, all Special Conditions of Contract should be filled in by the Employer prior to issuance of the Tendering Documents. Schedules and reports to be provided by Employer should be annexed.

SCC Clause	GCC Clause	Description
1	1.1	<p style="text-align: center;"><b>A. General</b></p> <p>The Employer is Medical Officer Incharge, P.O Box 104, Singida Regional Referral Hospital</p> <p>The Adjudicator is one who will be appointed by the Tanzanian Institute of Arbitrator</p> <p>The Defects Liability Period is 180 days.</p> <p>The Project Manager shall be known after completion of procurement process</p> <p>The Works consist of <b>Proposed Construction Emergence Medical Department (EMD) Building at Singida Regional Referral Hospital</b></p> <p>The Start Date shall be within 3 days from the date of Contract signing</p> <p>The Intended Completion Date for the whole of the Works shall be 4 Months</p> <p>The Site is located at Mandewa ward Singida Municipal Council</p>
2.	2.2	Indicate whether sectional completion is specified Refer Scc 1.1
3.	2.3(10)	List other documents that form part of the contract if any: Agreement, (2) Letter of Acceptance,

		<p>(3) Contractor's Bid,</p> <p>(4) Special Conditions of Contract,</p> <p>(5) General Conditions of Contract,</p> <p>(6) Specifications,</p> <p>(7) Drawings,</p> <p>(8) Bill of Quantities, and</p> <p>(9) Power of attorney</p>
4.	4.1	<p>The language of the Contract documents is English language.</p> <p>The law that applies to the Contract is the Laws of Tanzania.</p>
5	8.1	<p>Address for communication</p> <p>Employer's..... [insert address]</p> <p>Contractor's..... [insert address]</p>
6.	12.1	<p>Include the Schedule of Other Contractors, if any. N/A</p>
7.	13.1	<p>Include the Schedule of Key Personnel. N/A</p>
8.	17.1	<p>The minimum insurance covers shall be:</p> <p>(a) (a loss of or damage to the Works, Plant, and Materials</p> <p><i>Tsh 50,000,000</i></p> <p>(b) loss of or damage to Equipment <i>Tsh Tsh 50,000,000</i></p> <p>(c) loss of or damage to property (except the Works, Plant, Materials, and Equipment) in connection with the Contract <i>Tsh 50,000,000t</i> and</p> <p>(d) Personal injury or death <i>Tsh 20,000,000</i></p>
9.	18.1	<p>Site Investigation Reports available to the Tenderer are: N/A</p>
	25.1	<p>Unless otherwise state tax payment status.....</p>
10.	26.4	<p>The other measures include:</p> <p>a. Minimizing the number of migrant workers employed on the project and household in the site camp</p> <p>b. Providing access to voluntary counseling and testing (VCT)</p> <p>c. Providing psychological support and health care</p>

		including prevention and treatment of opportunistic infections for workers infected and affected, as well as their families  d. Providing condoms (male and female) to workers
11.	28.1	The Site Possession Date shall be <b>within 3 days after contract signing</b>
12.	32.2	If either Party is dissatisfied with the Adjudicator's decision may, refer the dispute for arbitration within [insert number of days] days
13	31.1	Appointing Authority for the Adjudicator: <b>Tanzanian Institute of arbitrator</b>
14.	32.3	Arbitration will take place at <i>Singida Tanzania</i> in accordance with rules and regulations
15.	35.1	Otherwise, state [insert the responsible person for security of the site]
<b>B. Time Control</b>		
16.	36.1	The Contractor shall Submit a Programme for the Works within <b>28 days</b> of delivery of the Letter of Acceptance.
17.	36.2	The period between Programme updates is <b>45 days</b> .
18.	36.2	The amount to be withheld by the Project Manager in the case the contractor does not submit an updated programme is: <b>10% of the remaining amount of the contract price during update time</b>
<b>C. Quality Control</b>		
19.	44.1	The Defects Liability Period is <b>180 days</b> .
<b>D. Cost Control</b>		
20	52.7	Minimum Amount of Interim Payment Certificate will be <b>will be 15% of the contract price</b>
21	54.1	The currency of payment shall be <b>Tanzanian shillings</b>
22.	57	The contract is <b>not</b> subject to price adjustment.
23.	58.1	The amount of retention is <b>10%</b> of value of works of Interim Payment Certificate'.  Limit of retention will be <b>10%</b> of contract price.

*shu*

24.	59.1	The amount of liquidated damages is <b>0.1 percent</b> of contract price
		The maximum amount of liquidated damages must be equivalent to the amount of the performance security <b>known during contract signing</b>
25.	60.1	The bonus for early completion is N/A
26.	61.1	The amount of advance payment shall be 15 percent of the contract sum payable.
		Monthly Recovery of Advance Payment <b>shall be recovered into two certificates.</b>
27.	62.1	The Performance Security shall be a minimum amount equivalent to <b>10 percent</b> of the contract price.
28	66.1	Contractor shall handover the site and the works to the Employer <i>within within 3 days after Certificate of Completion is issued]</i>
		<b>E. Discharge of the Contract</b>
29.	68.1	As built drawings shall be supplied by the contractor.
		Operating manual shall be supplied by the contractor by <i>[insert date if applicable].N/A</i>
30.	68.2	The amount to be withheld by the Project Manager in the case the contractor does not submit as built drawings is: <b>10%</b> of contract sum
		The amount to be withheld by the Project Manager in the case the contractor does not submit operating manual is: N/A
31.	69.2 (i)	Number of days for which the maximum amount of liquidated damages can be paid is <b>100 days</b>
32.	70.1	The percentage to apply to the value of the work not completed, representing the Employer's additional cost for completing the Works, is <b>30% of the value of the completed contractor's work required to be paid during termination of contract</b>

**GENERAL CONDITION OF THE  
CONTRACT**

## A. General

### 1. Definitions 1.1 Boldface type is used to identify defined terms.

The **Adjudicator** is the person appointed jointly by the Employer and the Contractor to resolve disputes in the first instance, as provided for in Clauses 24 and 25 hereunder.

**Bill of Quantities** means the priced and completed Bill of Quantities forming part of the Bid.

**Compensation Events** are those defined in Clause 47 hereunder.

The **Completion Date** is the date of completion of the Works as certified by the Project Manager, in accordance with Sub-Clause 55.1.

The **Contract** is the Contract between the Employer and the Contractor to execute, complete, and maintain the Works. It consists of the documents listed in Clause 2.3 below.

The **Contractor** is a person or corporate body whose Bid to carry out the Works has been accepted by the Employer.

The **Contractor's Tender** is the completed bidding document submitted by the Contractor to the Employer.

The **Contract Price** is the price stated in the Letter of Acceptance and thereafter as adjusted in accordance with the provisions of the Contract.

**Days** are calendar days; months are calendar months.

**Dayworks** are varied work inputs subject to payment on a time basis for the Contractor's employees and Equipment, in addition to payments for associated Materials and Plant.

A **Defect** is any part of the Works not completed in accordance with the Contract.

The **Defects Liability Certificate** is the certificate issued by Project Manager upon correction of defects by the Contractor.

The **Defects Liability Period** is the period named in the **Special Conditions of Contract** and calculated from the Completion Date.

**Drawings** include calculations and other information provided or approved by the Project Manager for the



execution of the Contract.

The **Employer** is the party who employs the Contractor to carry out the Works.

**Equipment** is the Contractor's machinery and vehicles brought temporarily to the Site to construct the Works.

The **Initial Contract Price** is the Contract Price listed in the Employer's Letter of Acceptance.

The **Intended Completion Date** is the date on which it is intended that the Contractor shall complete the Works. The Intended Completion Date is specified in the **Special Conditions of Contract**. The Intended Completion Date may be revised only by the Project Manager by issuing an extension of time or an acceleration order.

**Materials** are all supplies, including consumables, used by the Contractor for incorporation in the Works.

**Plant** is any integral part of the Works that shall have a mechanical, electrical, chemical, or biological function.

The **Project Manager** is the person named in the **Special Conditions of Contract** (or any other competent person appointed by the Employer and notified to the Contractor, to act in replacement of the Project Manager) who is responsible for supervising the execution of the Works and administering the Contract.

The **Site** is the area defined as such in the **Special Conditions of Contract**.

**Site Investigation Reports** are those that were included in the bidding documents and are factual and interpretative reports about the surface and subsurface conditions at the Site.

**Specification** means the Specification of the Works included in the Contract and any modification or addition made or approved by the Project Manager.

The **Start Date** is given in the **Special Conditions of Contract**. It is the latest date when the Contractor shall commence execution of the Works. It does not necessarily coincide with any of the Site Possession Dates.

A **Subcontractor** is a person or corporate body who has a

Contract with the Contractor to carry out a part of the work in the Contract, which includes work on the Site.

**Temporary Works** are works designed, constructed, installed, and removed by the Contractor that are needed for construction or installation of the Works.

A **Variation** is an instruction given by the Project Manager that varies the Works.

The **Works** are what the Contract requires the Contractor to construct, install, and turn over to the Employer, as defined in the **Special Conditions of Contract**.

Force Majeure" means an event which is beyond the reasonable control of a Party and which makes a Party's performance of its obligations under the Contract impossible or so impractical as to be considered impossible under the circumstances.

## 2. Interpretation

- 2.1 In interpreting these Conditions of Contract, singular also means plural, male also means female or neuter, and the other way around. Headings have no significance. Words have their normal meaning under the language of the Contract unless specifically defined. The Project Manager will provide instructions clarifying queries about these Conditions of Contract.
- 2.2 If sectional completion is specified in the **Special Conditions of Contract**, references in the Conditions of Contract to the Works, the Completion Date, and the Intended Completion Date apply to any Section of the Works (other than references to the Completion Date and Intended Completion Date for the whole of the Works).
- 2.3 The documents forming the Contract shall be interpreted in the following order of priority:
- (1) Agreement,
  - (2) Letter of Acceptance,
  - (3) Contractor's Bid,
  - (4) Special Conditions of Contract,
  - (5) Conditions of Contract,
  - (6) Specifications,
  - (7) Drawings,
  - (8) Bill of Quantities, and

(9) Power of Attorney

3. **Language and Law** 3.1 The language of the Contract and the law governing the Contract are stated in the **Special Conditions of Contract**.
4. **Confidentiality** 4.1 The Service Providers, their Subcontractors, and the Personnel of either of them shall not disclose any proprietary or confidential information relating to the Project, the Services, this Contract, or the Employer's business or operations without the prior written consent of the Employer.
5. **Project Manager's Decisions** 5.1 Except where otherwise specifically stated, the Project Manager will decide contractual matters between the Employer and the Contractor in the role representing the Employer.
6. **Delegation** 6.1 The Project Manager may delegate any of his duties and responsibilities to other people, except to the Adjudicator, after notifying the Contractor, and may cancel any delegation after notifying the Contractor.
7. **Communications** 7.1 Communications between parties that are referred to in the Conditions shall be effective only when in writing. A notice shall be effective only when it is delivered.
8. **Subcontracting** 8.1 The Contractor may subcontract with the approval of the Project Manager, but may not assign the Contract without the approval of the Employer in writing. Subcontracting shall not alter the Contractor's obligations.
9. **Other Contractors** 9.1 The Contractor shall cooperate and share the Site with other contractors, public authorities, utilities, and the Employer between the dates given in the Schedule of Other Contractors, as referred to in the **Special Conditions of Contract**. The Contractor shall also provide facilities and services for them as described in the Schedule. The Employer may modify the Schedule of Other Contractors, and shall notify the Contractor of any such modification
10. **Personnel** 10.1 The Contractor shall employ the key personnel named in the Schedule of Key Personnel, as referred to in the **Special Conditions of Contract**, to carry out the functions stated in the Schedule or other personnel approved by the Project Manager. The Project Manager will approve any proposed replacement of key personnel only if their relevant qualifications and abilities are substantially equal to or better than those of the personnel listed in the Schedule.



- 10.2 If the Project Manager asks the Contractor to remove a person who is a member of the Contractor's staff or work force, stating the reasons, the Contractor shall ensure that the person leaves the Site within seven days and has no further connection with the work in the Contract.
- 11. Employer's and Contractor's Risks**
- 11.1 The Employer carries the risks which this Contract states are Employer's risks, and the Contractor carries the risks which this Contract states are Contractor's risks.
- 12. Employer's Risks**
- 12.1 From the Start Date until the Defects Correction Certificate has been issued, the following are Employer's risks:
- (a) The risk of personal injury, death, or loss of or damage to property (excluding the Works, Plant, Materials, and Equipment), which are due to
    - (i) use or occupation of the Site by the Works or for the purpose of the Works, which is the unavoidable result of the Works or
    - (ii) negligence, breach of statutory duty, or interference with any legal right by the Employer or by any person employed by or contracted to him except the Contractor.
  - (a) The risk of damage to the Works, Plant, Materials, and Equipment to the extent that it is due to a fault of the Employer or in the Employer's design, or due to war or radioactive contamination directly affecting the country where the Works are to be executed.
- 12.2 From the Completion Date until the Defects Correction Certificate has been issued, the risk of loss of or damage to the Works, Plant, and Materials is an Employer's risk except loss or damage due to
- (a) a Defect which existed on the Completion Date,
  - (b) an event occurring before the Completion Date, which was not itself an Employer's risk, or
  - (c) the activities of the Contractor on the Site after the Completion Date.
- 13. Contractor's Risks**
- 13.1 From the Starting Date until the Defects Correction Certificate has been issued, the risks of personal injury, death, and loss of or damage to property (including, without limitation, the Works, Plant, Materials, and Equipment)

which are not Employer's risks are Contractor's risks.

#### 14. Insurance

14.1 The Contractor shall provide, in the joint names of the Employer and the Contractor, insurance cover from the Start Date to the end of the Defects Liability Period, in the amounts and deductibles stated in the **Special Conditions of Contract** for the following events which are due to the Contractor's risks:

- (a) loss of or damage to the Works, Plant, and Materials;
- (b) loss of or damage to Equipment;
- (c) loss of or damage to property (except the Works, Plant, Materials, and Equipment) in connection with the Contract; and
- (d) personal injury or death.

14.2 Policies and certificates for insurance shall be delivered by the Contractor to the Project Manager for the Project Manager's approval before the Start Date. All such insurance shall provide for compensation to be payable in the types and proportions of currencies required to rectify the loss or damage incurred.

14.3 If the Contractor does not provide any of the policies and certificates required, the Employer may effect the insurance which the Contractor should have provided and recover the premiums the Employer has paid from payments otherwise due to the Contractor or, if no payment is due, the payment of the premiums shall be a debt due.

14.4 Alterations to the terms of an insurance shall not be made without the approval of the Project Manager.

14.5 Both parties shall comply with any conditions of the insurance policies.

#### 15. Site Investigation Reports

15.1 The Contractor, in preparing the Bid, shall rely on any Site Investigation Reports referred to in the **Special Conditions of Contract**, supplemented by any information available to the Tenderer.

#### 16. Queries about the Special Conditions of Contract

16.1 The Project Manager will clarify queries on the **Special Conditions of Contract**.

- 17. Contractor to Construct the Works** 17.1 The Contractor shall construct and install the Works in accordance with the Specifications and Drawings.
- 18. Commencement and Completion** 18.1 The Contractor may commence execution of the Works on the Start Date and shall carry out the Works in accordance with the Programme submitted by the Contractor, as updated with the approval of the Project Manager, and complete them by the Intended Completion Date.
- 19. Approval by the Project Manager** 19.1 The Contractor shall submit Specifications and Drawings showing the proposed Temporary Works to the Project Manager, who is to approve them if they comply with the Specifications and Drawings.
- 19.2 The Contractor shall be responsible for design of Temporary Works.
- 19.3 The Project Manager's approval shall not alter the Contractor's responsibility for design of the Temporary Works.
- 19.4 The Contractor shall obtain approval of third parties to the design of the Temporary Works, where required.
- 19.5 All Drawings prepared by the Contractor for the execution of the temporary or permanent Works, are subject to prior approval by the Project Manager before this use.
- 20. Protection of the Environment** 20.1 The Contractors shall take all reasonable steps to protect the environment and to limit damage and nuisance to people and property resulting from pollution, noise and other results of his operations.
- 20.2 The Contractors shall ensure that emissions, surface discharges and effluent from his activities shall not exceed prescribed values in the environmental laws.
- 21. Labour Laws** 21.1 The Contractor shall comply with all the relevant labour laws applicable in the Country, including laws relating to workers employment, working hours, health, safety, welfare, and immigration and shall allow them all their legal rights.
- 21.2 The Contractor shall require his employees to obey all applicable laws, including those concerning safety at work.
- 22. Health and Safety** 22.1 The Contractor shall at all times take all reasonable precautions to maintain the health and safety of his

personnel.

22.2 The Contractor shall ensure that first aid facilities are available at all times at the site and that suitable arrangements are made for all necessary welfare and hygiene requirements and for the prevention of epidemics.

22.3 The Contractor shall notify the Employer details of any accident as soon as practicable after its occurrence. The Contractor shall maintain records and make reports concerning health, safety, and welfare of persons, and damage to the property, as the Employer may reasonably require.

22.4 The Contractor shall conduct an HIV-Aids awareness programme, and shall take other such measures as specified in the **Special Conditions of Contractor** to reduce the risk of transfer of HIV virus between and among Contractor personnel, the Employers Staff and the surrounding community.

**23. Discoveries**

23.1 Anything of historical or other interest or of significant value unexpectedly discovered on the Site shall be the property of the Employer. The Contractor shall notify the Project Manager of such discoveries and carry out the Project Manager's instructions for dealing with them.

**24. Possession of the Site**

24.1 The Employer shall give possession of all parts of the Site to the Contractor. If possession of a part is not given by the date stated in the **Special Conditions of Contract**, the Employer will be deemed to have delayed the start of the relevant activities, and this will be a Compensation Event.

**25. Access to the Site**

25.1 The Contractor shall allow the Project Manager and any person authorized by the Project Manager access to the Site and to any place where work in connection with the Contract is being carried out or is intended to be carried out.

**26. Instructions, Inspections and Audits**

26.1 The Contractor shall carry out all instructions of the Project Manager which comply with the applicable laws where the Site is located.

26.2 The Contractor shall permit the Government of the United Republic of Tanzania to inspect the Contractor's accounts and records relating to the performance of the Contractor and to have them audited by auditors appointed by the Government of the United Republic of Tanzania, if so required by the Government of the United Republic of

- 27. Disputes**
- 27.1 If the Contractor believes that a decision taken by the Project Manager was either outside the authority given to the Project Manager by the Contract or that the decision was wrongly taken, the decision shall be referred to the Adjudicator within 14 days of the notification of the Project Manager's decision.
- 28. Procedure for Disputes**
- 28.1 The Adjudicator shall give a decision in writing within 28 days of receipt of a notification of a dispute.
- 28.2 The Adjudicator shall be paid by the hour at the rate specified in the **Tender Data Sheet** and **Special Conditions of Contract**, together with reimbursable expenses of the types specified in the **Special Conditions of Contract**, and the cost shall be divided equally between the Employer and the Contractor, whatever decision is reached by the Adjudicator. Either party may refer a decision of the Adjudicator to an Arbitrator within 28 days of the Adjudicator's written decision. If neither party refers the dispute to arbitration within the above 28 days, the Adjudicator's decision will be final and binding.
- 28.3 The arbitration shall be conducted in accordance with the arbitration procedure published by the institution named and in the place shown in the **Special Conditions of Contract**.<sup>1</sup>
- 29. Replacement of Adjudicator**
- 29.1 Should the Adjudicator resign or die, or should the Employer and the Contractor agree that the Adjudicator is not functioning in accordance with the provisions of the Contract, a new Adjudicator will be jointly appointed by the Employer and the Contractor. In case of disagreement between the Employer and the Contractor, within 30 days, the Adjudicator shall be designated by the Appointing Authority designated in the **Special Conditions of Contract** at the request of either party, within 14 days of receipt of such request.



## B. Time Control

30. Programme
- 30.1 Within the time stated in the **Special Conditions of Contract**, the Contractor shall submit to the Project Manager for approval a Programme showing the general methods, arrangements, order, and timing for all the activities in the Works.
- 30.2 An update of the Programme shall be a programme showing the actual progress achieved on each activity and the effect of the progress achieved on the timing of the remaining work, including any changes to the sequence of the activities.
- 30.3 The Contractor shall submit to the Project Manager for approval an updated Programme at intervals no longer than the period stated in the **Special Conditions of Contract**. If the Contractor does not submit an updated Programme within this period, the Project Manager may withhold the amount stated in the **Special Conditions of Contract** from the next payment certificate and continue to withhold this amount until the next payment after the date on which the overdue Programme has been submitted.
- 30.4 The Project Manager's approval of the Programme shall not alter the Contractor's obligations. The Contractor may revise the Programme and submit it to the Project Manager again at any time. A revised Programme shall show the effect of Variations and Compensation Events
31. Extension of the Intended Completion Date
- 31.1 The Project Manager shall extend the Intended Completion Date if a Compensation Event occurs or a Variation is issued which makes it impossible for Completion to be achieved by the Intended Completion Date without the Contractor taking steps to accelerate the remaining work, which would cause the Contractor to incur additional cost.
- 31.2 The Project Manager shall decide whether and by how much to extend the Intended Completion Date within 21 days of the Contractor asking the Project Manager for a decision upon the effect of a Compensation Event or Variation and submitting full supporting information. If the Contractor has failed to give early warning of a delay or has failed to cooperate in dealing with a delay, the delay by this failure shall not be considered in assessing the new Intended Completion Date.

32. Acceleration
- 32.1 When the Employer wants the Contractor to finish before the Intended Completion Date, the Project Manager will obtain priced proposals for achieving the necessary acceleration from the Contractor. If the Employer accepts these proposals, the Intended Completion Date will be adjusted accordingly and confirmed by both the Employer and the Contractor.
- 32.2 If the Contractor's priced proposals for an acceleration are accepted by the Employer, they shall be incorporated in the Contract Price and treated as a Variation.
33. Delays Ordered by the Project Manager
- 33.1 The Project Manager may instruct the Contractor to delay the start or progress of any activity within the Works.
34. Management Meetings
- 34.1 Either the Project Manager or the Contractor may require the other to attend a management meeting. The business of a management meeting shall be to review the plans for remaining work and to deal with matters raised in accordance with the early warning procedure.
- 34.2 The Project Manager shall record the business of management meetings and provide copies of the record to those attending the meeting and to the Employer. The responsibility of the parties for actions to be taken shall be decided by the Project Manager either at the management meeting or after the management meeting and stated in writing to all who attended the meeting.
35. Early Warning
- 35.1 The Contractor shall warn the Project Manager at the earliest opportunity of specific likely future events or circumstances that may adversely affect the quality of the work, increase the Contract Price or delay the execution of the Works. The Project Manager may require the Contractor to provide an estimate of the expected effect of the future event or circumstance on the Contract Price and Completion Date. The estimate shall be provided by the Contractor as soon as reasonably possible.
- 35.2 The Contractor shall cooperate with the Project Manager in making and considering proposals for how the effect of such an event or circumstance can be avoided or reduced by anyone involved in the work and in carrying out any resulting instruction of the Project Manager.

### C. Quality Control

36. Identifying Defects 36.1 The Project Manager shall check the Contractor's work and notify the Contractor of any Defects that are found. Such checking shall not affect the Contractor's responsibilities. The Project Manager may instruct the Contractor to search for a Defect and to uncover and test any work that the Project Manager considers may have a Defect.
37. Tests 37.1 If the Project Manager instructs the Contractor to carry out a test not specified in the Specification to check whether any work has a Defect and the test shows that it does, the Contractor shall pay for the test and any samples. If there is no Defect, the test shall be a Compensation Event.
38. Correction of Defects 38.1 The Project Manager shall give notice to the Contractor of any Defects before the end of the Defects Liability Period, which begins at Completion, and is defined in the **Special Conditions of Contract**. The Defects Liability Period shall be extended for as long as Defects remain to be corrected.
- 38.2 Every time notice of a Defect is given, the Contractor shall correct the notified Defect within the length of time specified by the Project Manager's notice.
- 38.3 If the Contractor has not corrected a defect within the time specified in the Employer's notice, a penalty for lack of performance will be paid by the Contractor. The amount to be paid will be calculated as a percentage of the cost of having the defect correct, assessed as described in Clause 49.
39. Uncorrected Defects 39.1 If the Contractor has not corrected a Defect within the time specified in the Project Manager's notice, the Project Manager will assess the cost of having the Defect corrected, and the Contractor will pay this amount.

### D. Cost Control

40. Bill of Quantities 40.1 The Bill of Quantities shall contain items for the construction, installation, testing, and commissioning work to be done by the Contractor.
- 40.2 The Bill of Quantities is used to calculate the Contract Price. The Contractor shall be paid for the quantity of the work done at the rate in the Bill of Quantities for each item.
41. Changes in the Quantities 41.1 If the final quantity of the work done differs from the quantity in the Bill of Quantities for the particular item by more than

25 percent, provided the change exceeds 1 percent of the Initial Contract Price, the Project Manager shall adjust the rate to allow for the change.

41.2 The Project Manager shall not adjust rates from changes in quantities if thereby the Initial Contract Price is exceeded by more than 15 percent, except with the prior approval of the Employer.

41.3 If requested by the Project Manager, the Contractor shall provide the Project Manager with a detailed cost breakdown of any rate in the Bill of Quantities.

#### **42. Variations**

42.1 All Variations shall be included in updated Programmes produced by the Contractor.

#### **43. Payments for Variations**

43.1 The Contractor shall provide the Project Manager with a quotation for carrying out the Variation when requested to do so by the Project Manager. The Project Manager shall assess the quotation, which shall be given within seven days of the request or within any longer period stated by the Project Manager and before the Variation is ordered.

43.2 If the work in the Variation corresponds with an item description in the Bill of Quantities and if, in the opinion of the Project Manager, the quantity of work above the limit stated in Sub-Clause 41.1 or the timing of its execution do not cause the cost per unit of quantity to change, the rate in the Bill of Quantities shall be used to calculate the value of the Variation. If the cost per unit of quantity changes, or if the nature or timing of the work in the Variation does not correspond with items in the Bill of Quantities, the quotation by the Contractor shall be in the form of new rates for the relevant items of work.

43.3 If the Contractor's quotation is unreasonable, the Project Manager may order the Variation and make a change to the Contract Price, which shall be based on the Project Manager's own forecast of the effects of the Variation on the Contractor's costs.

43.4 If the Project Manager decides that the urgency of varying the work would prevent a quotation being given and considered without delaying the work, no quotation shall be given and the Variation shall be treated as a Compensation Event.

43.5 The Contractor shall not be entitled to additional payment for costs that could have been avoided by giving early warning.

**44. Cash Flow Forecasts**

44.1 When the Programme is updated, the Contractor shall provide the Project Manager with an updated cash flow forecast. The cash flow forecast shall include different currencies, as defined in the Contract, converted as necessary using the Contract exchange rates.

**45. Payment Certificates**

45.1 The Contractor shall submit to the Project Manager monthly statements of the estimated value of the work executed less the cumulative amount certified previously.

45.2 The Project Manager shall check the Contractor's monthly statement and certify the amount to be paid to the Contractor within twenty eight 28 days of receipt of the certificate from the contractor.

45.3 The value of work executed shall be determined by the Project Manager.

45.4 The value of work executed shall comprise the value of the quantities of the items in the Bill of Quantities completed.

45.5 The value of work executed shall include the valuation of Variations and Compensation Events.

45.6 The Project Manager may exclude any item certified in a previous certificate or reduce the proportion of any item previously certified in any certificate in the light of later information.

45.7 The Project Manager shall not bound to certify any payment, if the net amount, after all retentions and deductions would be less than minimum amount of Interim Payment Certificate stated in the **Special Condition of Contract**.

**46. Payments**

46.1 Payments shall be adjusted for deductions for advance payments and retention. The Employer shall pay the Contractor the amounts certified by the Project Manager within 28 days of the date of each certificate. If the Employer makes a late payment, the Contractor shall be paid interest on the late payment in the next payment Interest shall be calculated from the date by which the payment should have been made up to the date when the late payment is made at the prevailing rate of interest for commercial borrowing for each of the currencies in which payments are made as indicated in the **Special Conditions of Contract**..

46.2 If an amount certified is increased in a later certificate or as a result of an award by the Adjudicator or an Arbitrator, the Contractor shall be paid interest upon the delayed payment as

set out in this clause. Interest shall be calculated from the date upon which the increased amount would have been certified in the absence of dispute.

#### 47. Compensation Events

46.3 Unless otherwise stated, all payments and deductions will be paid or charged in the proportions of currencies comprising the Contract Price.

46.4 Items of the Works for which no rate or price has been entered in will not be paid for by the Employer and shall be deemed covered by other rates and prices in the Contract.

47.1 The following shall be Compensation Events:

- (a) The Employer does not give access to a part of the Site by the Site Possession Date stated in the **Special Conditions of Contract**.
- (b) The Employer modifies the Schedule of Other Contractors in a way that affects the work of the Contractor under the Contract.
- (c) The Project Manager orders a delay or does not issue Drawings, Specifications, or instructions required for execution of the Works on time.
- (d) The Project Manager instructs the Contractor to uncover or to carry out additional tests upon work, which is then found to have no Defects.
- (e) The Project Manager unreasonably does not approve a subcontract to be let.
- (f) Ground conditions are substantially more adverse than could reasonably have been assumed before issuance of the Letter of Acceptance from the information issued to bidders (including the Site Investigation Reports), from information available publicly and from a visual inspection of the Site.
- (g) The Project Manager gives an instruction for dealing with an unforeseen condition, caused by the Employer, or additional work required for safety or other reasons.
- (h) Other contractors, public authorities, utilities, or the Employer does not work within the dates and other constraints stated in the Contract, and they cause delay or extra cost to the Contractor.

- (i) The advance payment is delayed.
- (j) The effects on the Contractor of any of the Employer's Risks.
- (k) The Project Manager unreasonably delays issuing a Certificate of Completion.
- (l) Other Compensation Events described in the Contract or determined by the Project Manager shall apply.

47.2 If a Compensation Event would cause additional cost or would prevent the work being completed before the Intended Completion Date, the Contract Price shall be increased and/or the Intended Completion Date shall be extended. The Project Manager shall decide whether and by how much the Contract Price shall be increased and whether and by how much the Intended Completion Date shall be extended.

47.3 As soon as information demonstrating the effect of each Compensation Event upon the Contractor's forecast cost has been provided by the Contractor, it shall be assessed by the Project Manager, and the Contract Price shall be adjusted accordingly. If the Contractor's forecast is deemed unreasonable, the Project Manager shall adjust the Contract Price based on the Project Manager's own forecast. The Project Manager will assume that the Contractor will react competently and promptly to the event.

47.4 The Contractor shall not be entitled to compensation to the extent that the Employer's interests are adversely affected by the Contractor's not having given early warning or not having cooperated with the Project Manager.

**48. Taxes**

48.1 The Project Manager shall adjust the Contract Price if taxes, duties, and other levies are changed between the date 28 days before the submission of bids for the Contract and the date of the last Completion certificate. The adjustment shall be the change in the amount of tax payable by the Contractor, provided such changes are not already reflected in the Contract Price or are a result of Clause 50.

**49. Currencies**

49.1 Where payments are made in currencies other than the Tanzania Shillings, the exchange rates used for calculating the amounts to be paid shall be the exchange rates stated in the Contractor's Bid.

**50. Price Adjustment**

50.1 The amounts payable to the Contractor, in various currencies pursuant to Sub-Clause 45.1, shall be adjusted in respect of

the rise or fall in the cost of labor, Contractor's Equipment, Plant, materials, and other inputs to the Works, by applying to such amounts the formulae prescribed in this clause.

50.2 To the extent that full compensation for any rise or fall in costs to the Contractor is not covered by the provisions of this or other clauses in the Contract, the unit rates and prices included in the Contract shall be deemed to include amounts to cover the contingency of such other rise or fall of costs.

50.3 The adjustment to be applied to amount payable to the Contractor as certified in Payment Certificates shall be determined formulae for each of the currencies in which the Contract Price is payable. No adjustment is to be applied to work valued on the basis of Cost or current prices. The formulae shall be as follows;

$$P_n = a + b \frac{L_n - L_o}{L_o} + c \frac{M_n - M_o}{M_o} + d \frac{E_n - E_o}{E_o} + \text{etc.}$$

where;

$P_n$  is a price adjustment factor to be applied to the amount in each specific currency for the payment of the work carried out in the subject month, where such variations and daywork are not otherwise subject to adjustment;

$a$  is a constant, specified in the **Appendix to Bid**, representing the nonadjustable portion in contractual payments;

$b$ ,  $c$ ,  $d$ , etc., are weightings or coefficients representing the estimated proportion of each cost element (labor, materials, equipment usage, etc.) in the Works or sections thereof, net of Provisional Sums, as specified in the **Appendix to Bid**; the sum of  $a$ ,  $b$ ,  $c$ ,  $d$ , etc., shall be one;

$L_n$ ,  $M_n$ ,  $E_n$ , etc., are the current cost indices or reference prices of the cost elements in the specific currency of origin for month "n," determined pursuant to Sub-Clause 50.5, applicable to each cost element; and

$L_o$ ,  $M_o$ ,  $E_o$ , etc., are the base cost indices or reference prices corresponding to the above cost elements at the date specified in Sub-Clause 50.5

The value of net work done, certified by the Project Manager, in any monthly Interim or Final Certificate as payable by the Employer to the Contractor before deduction of any retention



money shall be increased or decreased by an amount of 'F'.

$$F = Pn \times Pc$$

where;

The effective value  $Pc$  of work done which is to be subjected to increase or decrease shall be the difference between:

- (i) the amount which, in the opinion of the Project Manager, is due to the Contractor under Clause 45 (before deduction of retention money and before deducting sums previously paid on account) less:
  - any amount for payment or repayment of any advance payment;
  - any amount for materials on site (if any);
  - any amounts for nominated sub-contractors (if any)
  - any amounts for any other items based on actual cost or current prices; or
  - any sums for increase or decreases in the Contract Price paid under this Sub-Clause

and

- (ii) the amount calculated in accordance with (i) above of this Sub-clause and included in the last preceding statement.

50.4 The sources of indices shall be those listed in the **Appendix to Bid**, as approved by the Engineer. Indices shall be appropriate for their purpose and shall relate to the Contractor's proposed source of supply of inputs on the basis of which his Contract Price and expected foreign currency requirements shall have been computed. As the proposed basis for price adjustment, the Contractor shall have submitted with his bid the tabulation of Weightings and Source of Indices in the **Appendix to Bid**, which shall be subject to approval by the Engineer.

50.5 The base cost indices or prices shall be those prevailing on the day 28 days prior to the latest date for submission of bids. Current indices or prices shall be those prevailing on the day 28 days prior to the last day of the period to which a particular Interim Payment Certificate is related. If at any time the current indices are not available, provisional indices as determined by the Engineer will be used, subject to subsequent correction of the amounts paid to the Contractor when the current indices become available.

50.6 If the Contractor fails to complete the Works within the time

for completion prescribed under Clause 58 adjustment of prices thereafter until the date of completion of the Works shall be made using either the indices or prices relating to the prescribed time for completion, or the current indices or prices, whichever is more favorable to the Employer, provided that if an extension of time is granted pursuant to Clause 28, the above provision shall apply only to adjustments made after the expiry of such extension of time.

50.7 The weightings for each of the factors of cost given in the **Appendix to Bid** shall be adjusted if, in the opinion of the Engineer, they have been rendered unreasonable, unbalanced, or inapplicable as a result of varied or additional work already executed or instructed under Clause 43 or for any other reason.

#### 51. Retention

51.1 The Employer shall retain from each payment due to the Contractor the proportion stated in the **Special Conditions of Contract** until Completion of the whole of the Works.

51.2 On completion of the whole of the Works, half the total amount retained shall be repaid to the Contractor and the other half when the Defects Liability Period has passed and the Project Manager has certified that all Defects notified by the Project Manager to the Contractor before the end of this period have been corrected.

51.3 On completion of the whole Works, the Contractor may substitute retention money with an "on demand" Bank guarantee.

#### 52. Liquidated Damages

52.1 The Contractor shall pay liquidated damages to the Employer at the rate per day stated in the **Special Conditions of Contract** for each day that the Completion Date is later than the Intended Completion Date. The total amount of liquidated damages shall not exceed the amount defined in the **Special Conditions of Contract**. The Employer may deduct liquidated damages from payments due to the Contractor. Payment of liquidated damages shall not affect the Contractor's liabilities.

52.2 If the Intended Completion Date is extended after liquidated damages have been paid, the Project Manager shall correct any overpayment of liquidated damages by the Contractor by adjusting the next payment certificate. The Contractor shall be paid interest on the overpayment, calculated from the date of payment to the date of repayment, at the rates specified in

Sub-Clause 46.1.

52.3 If the Contractor has not corrected a defects within the time specified in the Employer's notice, the Employer will assess the cost of having the defect corrected, the Contractor will pay this amount, and a penalty for lack of performance calculated as described in Clause 38.

**53. Bonus**

53.1 The Contractor shall be paid a Bonus calculated at the rate per calendar day stated in the **Special Conditions of Contract** for each day (less any days for which the Contractor is paid for acceleration) that the Completion is earlier than the Intended Completion Date. The Project Manager shall certify that the Works are complete, although they may not be due to be complete.

**54. Advance  
Payment**

54.1 The Employer shall make advance payment to the Contractor of the amounts stated in the **Special Conditions of Contract** by the date stated in the **Special Conditions of Contract**, against provision by the Contractor of an Unconditional Bank Guarantee in a form and by a bank acceptable to the Employer in amounts and currencies equal to the advance payment. The Guarantee shall remain effective until the advance payment has been repaid, but the amount of the Guarantee shall be progressively reduced by the amounts repaid by the Contractor. Interest will not be charged on the advance payment.

54.2 The Contractor is to use the advance payment only to pay for Equipment, Plant, Materials, and mobilization expenses required specifically for execution of the Contract. The Contractor shall demonstrate that advance payment has been used in this way by supplying copies of invoices or other documents to the Project Manager.

54.3 The advance payment shall be repaid by deducting proportionate amounts from payments otherwise due to the Contractor, following the schedule of completed percentages of the Works on a payment basis. No account shall be taken of the advance payment or its repayment in assessing valuations of work done, Variations, price adjustments, Compensation Events, Bonuses, or Liquidated Damages.

**55. Performance  
Securities**

55.1 The Performance Security shall be provided to the Employer no later than the date specified in the Letter of Acceptance and shall be issued in an amount and form and by a bank or surety acceptable to the Employer, and denominated in the types and proportions of the currencies in which the Contract

Price is payable. The Performance Security shall be valid until a date 28 days from the date of issue of the Certificate of Completion in the case of a Bank Guarantee, and until one year from the date of issue of the Completion Certificate in the case of a Performance Bond.

- 56. Dayworks**
- 56.1 If applicable, the Dayworks rates in the Contractor's Bid shall be used for small additional amounts of work only when the Project Manager has given written instructions in advance for additional work to be paid for in that way.
- 56.2 All work to be paid for as Dayworks shall be recorded by the Contractor on forms approved by the Project Manager. Each completed form shall be verified and signed by the Project Manager within two days of the work being done.
- 56.3 The Contractor shall be paid for Dayworks subject to obtaining signed Dayworks forms.
- 57. Cost of Repairs**
- 57.1 Loss or damage to the Works or Materials to be incorporated in the Works between the Start Date and the end of the Defects Correction periods shall be remedied by the Contractor at the Contractor's cost if the loss or damage arises from the Contractor's acts or omissions.

#### E. Finishing the Contract

- 58. Completion Certificate**
- 58.1 The Contractor shall request the Project Manager to issue a certificate of Completion of the Works, and the Project Manager will do so upon deciding that the work is completed.
- 59. Taking Over**
- 59.1 The Employer shall take over the Site and the Works within seven days of the Project Manager's issuing a certificate of Completion.
- 60. Final Account**
- 60.1 The Contractor shall supply the Project Manager with a detailed account of the total amount that the Contractor considers payable under the Contract before the end of the Defects Liability Period. The Project Manager shall issue a Defects Liability Certificate and certify any final payment that is due to the Contractor within 56 days of receiving the Contractor's account if it is correct and complete. If it is not, the Project Manager shall issue within 56 days a schedule that states the scope of the corrections or additions that are necessary. If the Final Account is still unsatisfactory after it has been resubmitted, the Project Manager shall decide on the amount payable to the Contractor and issue a payment certificate.

61. Operating and Maintenance Manuals
- 60.1 If "as built" Drawings and/or operating and maintenance manuals are required, the Contractor shall supply them by the dates stated in the **Special Conditions of Contract**.
- 60.2 If the Contractor does not supply the Drawings and/or manuals by the dates stated in the **Special Conditions of Contract**, or they do not receive the Project Manager's approval, the Project Manager shall withhold the amount stated in the **Special Conditions of Contract** from payments due to the Contractor.
62. Termination
- 62.1 The Employer or the Contractor may terminate the Contract if the other party causes a fundamental breach of the Contract.
- 62.2 Fundamental breaches of Contract shall include, but shall not be limited to, the following:
- (a) the Contractor stops work for 28 days when no stoppage of work is shown on the current Programme and the stoppage has not been authorized by the Project Manager;
  - (b) the Project Manager instructs the Contractor to delay the progress of the Works, and the instruction is not withdrawn within 28 days;
  - (c) the Employer or the Contractor is made bankrupt or goes into liquidation other than for a reconstruction or amalgamation;
  - (d) a payment certified by the Project Manager is not paid by the Employer to the Contractor within 84 days of the date of the Project Manager's certificate;
  - (e) the Project Manager gives Notice that failure to correct a particular Defect is a fundamental breach of Contract and the Contractor fails to correct it within a reasonable period of time determined by the Project Manager;
  - (f) the Contractor does not maintain a Security, which is required; and
  - (g) the Contractor has delayed the completion of the Works by the number of days for which the maximum amount of liquidated damages can be paid, as defined in the **Special Conditions of Contract**.
  - (h) if the Contractor, in the judgment of the Employer has engaged in corrupt or fraudulent practices in competing for or in executing the Contract.

For the purpose of this paragraph:

“corrupt practice” means the offering, giving, receiving or soliciting of any thing of value to influence the action of a public official in the procurement process or in contract execution and includes inter alia, bribery and extortion or coercion which involves threats of injury to person, property or reputation, and.

“fraudulent practice” means a misrepresentation of facts in order to influence a procurement process or the execution of a contract to the detriment of the Employer, and includes collusive practice among Bidders (prior to or after bid submission) designed to establish bid prices at artificial non-competitive levels and to deprive the Employer of the benefits of free and open competition.

62.3 When either party to the Contract gives notice of a breach of Contract to the Project Manager for a cause other than those listed under Sub-Clause 62.2 above, the Project Manager shall decide whether the breach is fundamental or not.

62.4 Notwithstanding the above, the Employer may terminate the Contract for convenience.

62.5 If the Contract is terminated, the Contractor shall stop work immediately, make the Site safe and secure, and leave the Site as soon as reasonably possible.

**63. Payment  
upon  
Termination**

63.1 If the Contract is terminated because of a fundamental breach of Contract by the Contractor, the Project Manager shall issue a certificate for the value of the work done and Materials ordered less advance payments received up to the date of the issue of the certificate and less the percentage to apply to the value of the work not completed, as indicated in the **Special Conditions of Contract**. Additional Liquidated Damages shall not apply. If the total amount due to the Employer exceeds any payment due to the Contractor, the difference shall be a debt payable to the Employer.

63.2 If the Contract is terminated for the Employer’s convenience or because of a fundamental breach of Contract by the Employer, the Project Manager shall issue a certificate for the value of the work done, Materials ordered, the reasonable cost of removal of Equipment, repatriation of the Contractor’s personnel employed solely on the Works, and the Contractor’s costs of protecting and securing the Works, and less advance payments received up to the date of the certificate.



- 64. Property** 64.1 All Materials on the Site, Plant, Equipment, Temporary Works, and Works shall be deemed to be the property of the Employer if the Contract is terminated because of the Contractor's default.
- 65. Release from Performance** 65.1 If the Contract is frustrated by the outbreak of war or by any other event entirely outside the control of either the Employer or the Contractor, the Project Manager shall certify that the Contract has been frustrated. The Contractor shall make the Site safe and stop work as quickly as possible after receiving this certificate and shall be paid for all work carried out before receiving it and for any work carried out afterwards to which a commitment was made.
- 66. Suspension of Financing** 66.1 In the event that the source of financing is suspended to the Employer, from which part of the payments to the Contractor are being made:
- (a) The Employer is obligated to notify the Contractor of such suspension within 7 days of having received the financing agency's suspension notice.
  - (b) If the Contractor has not received sums due it within the 28 days for payment provided for in Sub-Clause 46.1, the Contractor may immediately issue a 14-day termination notice.

**STATEMENT OF REQUIREMENTS  
AND SCHEDULE OF PRICE**

*th*



ITEM	DESCRIPTION	QTY	UNIT	RATE	AMOUNT
	<b>ELEMENT NO.1- SUBSTRUCTURE ALL PROVISIONAL</b>				
a	200mm hardcore stone - (4.5 m3 Lorry)	43	Trips	130,000	5,590,000
b	Sand blinding	9	Trips	90,000	810,000
c	soil sterilization over hardcore bed.	840	M <sup>2</sup>	500	420,000
d	Earth filling selected imported pure sand; well compacted in 300mm thick layers; to make up levels under the floors	20	Trips	80,000	1,600,000
e	Load up surplus excavated materials and remove from site	20	Trips	50,000	1,000,000
	<b><u>CONCRETE WORK</u></b>				
	<u>50mm blinding 1:4:8</u>				
f	cement - 50 Kgs 42.5	109	Bags	19,000	2,071,000
g	sand	5	Trips	90,000	450,000
h	aggregates (1/2")	10	Trips	350,000	3,500,000
	<u>Plain concrete grade '20'( 1:2:4)</u> <u>150mm over site bed</u>				
j	cement - 50 Kgs 42.5	1,194	Bags	19,000	22,686,000
k	sand	19	Trips	90,000	1,710,000
l	aggregates- 1/2"	38	Trips	350,000	13,300,000
	<b><u>Reinforcement</u></b>				
m	Fabric reinforcement to BS 4483 ref. A252 weighing 3.95 kg per square metre laid in bed and ramps	995	M <sup>2</sup>	6,000	5,970,000
	To Collection				<b>59,107,000</b>



ITEM	DESCRIPTION	QTY	UNIT	RATE	AMOUNT
	<b>Reinforced concrete grade 20 to:-</b>				
	<u>Ground beams</u>				
a	cement - 50 Kgs 42.5	216	Bags	19,000	4,104,000
b	sand	3.36	Trips	90,000	302,400
c	aggregates- 3/4"	6.72	Trips	350,000	2,352,000
d	Y16 Reinforcement bars;12 metres long	199	No	40,000	7,960,000
e	Y8 Reinforcement bars;12 metres long	295	No	16,000	4,720,000
f	Binding wires	15	Kgs	3,500	52,500
	<u>Columns bases &amp; starter columns</u>				
g	cement - 50 Kgs 42.5	36	Bags	19,000	684,000
h	sand	0.56	Trips	90,000	50,400
j	aggregates- 3/4"	1.12	Trips	350,000	392,000
	<u>Reinforcement bars;12 metres long</u>				
k	Y12 Reinforcement bars;12 metres long	40	No	28,000	1,120,000
l	Y8 Reinforcement bars;12 metres long	25	No	16,000	400,000
m	Binding wires	6	Kgs	3,500	21,000
	To Collection				22,158,300



ITEM	DESCRIPTION	QTY	UNIT	RATE	AMOUNT
	<b>Walling</b>				
	<b>Solid concrete blocks to B.S 2028 type 'A' bedded and jointed in cement and sand mortar (1:4)</b>				
a	6" cement and sand block- 5Mpa (230mm thick) <u>block making mortar</u>	8,527	No	1,500	12,790,500
b	cement - 50 Kgs 42.5	244	Bags	19,000	4,628,943
c	sand	8	Trips	90,000	720,000
d	SIKAFLEX-PRO 2HP ISOLATION JOINT; for expansion joint sealant applied in accordance to Manufacturer's specifications to 150mm deep concrete slab	27	M	25,000	675,000
	<b>Damp Proof Courses</b>				
e	DPM Sheets 1000gauge	877	M <sup>2</sup>	2,000	1,754,000
f	dpc ;230mm wide	34	Roll	130,000	4,420,000
g	Allow cost for construction of reinforced ramps as per project manager's instructions	4	No	300,000	1,200,000
	<b>15mm thick plaster to plinth level (1:4)</b>				
h	cement - 50 Kgs 42.5	15	Bags	19,000	285,000
j	sand for mortar	0.5	Trips	90,000	45,000
k	4lts black bituminous paint	8	4 LtrsT	25,000	200,000
	To Collection				26,718,443



ITEM	DESCRIPTION	QTY	UNIT	RATE	AMOUNT
	<b><u>Formwork</u></b>				
a	1x8"x3.5m cypress or other approved	300	No	14,000	4,200,000
b	2x4"x3.5m struts	100	No	7,000	700,000
c	props	50	No	4,000	200,000
d	Marine boards - Bamboo (9mm thick)	50	No	80,000	4,000,000
e	Assorted nails	50	No	3,500	175,000
	To Collection				9,275,000
	 <b><u>COLLECTION</u></b>				
	Page 1				59,107,000
	Page 2				22,158,300
	Page 3				26,718,443
	Page 4				9,275,000
	<b>TOTAL SUBSTRUCTURE TO SUMMARY</b>				<b>117,258,743</b>



ITEM	DESCRIPTION	QTY	UNIT	RATE	AMOUNT
	<b>ELEMENT NO.2- SUPERSTRUCTURE</b>				
	<b><u>FRAMES</u></b>				
	<b><u>Reinforced concrete grade 20</u></b>				
	<b><u>Ring beams, Columns and Horizontal</u></b>				
	<b><u>suspended Slab</u></b>				
a	cement - 50 Kgs 42.5	534	Bags	15,000	8,010,000
b	sand	8	Trips	90,000	720,000
c	aggregates- 3/4"	16	Trips	350,000	5,600,000
	<b><u>High yield hot rolled deformed steel bar</u></b>				
	<b><u>to B.S. 4449:1969</u></b>				
d	Y12 Reinforcement bars;12 metres long	318	No	28,000	8,904,000
e	Y8 Reinforcement bars;12 metres long	243	No	16,000	3,888,000
f	binding wires	30	Kgs	3,500	105,000
	<b><u>Walling</u></b>				
	<b><u>Solid concrete blocks to B.S 2028 type 'A'</u></b>				
	<b><u>bedded and jointed in cement and sand</u></b>				
	<b><u>mortar (1:4)</u></b>				
g	6" cement and sand block- 5Mpa (230mm t	18,876	No	1,500	28,314,000
	<b><u>block making mortar</u></b>				
h	cement - 50 Kgs 42.5	539	Bags	15,000	8,085,000
j	sand	18	Trips	100,000	1,800,000
	To Collection				65,426,000

ITEM	DESCRIPTION	QTY	UNIT	RATE	AMOUNT
	<b><u>Walling</u></b>				
	<b><u>Solid concrete blocks to B.S 2028 type 'A' bedded and jointed in cement and sand mortar (1:4)</u></b>				
a	6" cement and sand- 5Mpa (150mm thick) <u>block making mortar</u>	2,763	No	1,500	4,144,500
b	cement - 50 Kgs 42.5	79	Bags	19,000	1,499,914
c	sand	3	Trips	100,000	300,000
	<b><u>CONCRETE WORK</u></b>				
	<b><u>Precast concrete grade "25" including hoisting to position, bedding and pointing in cement mortar (1:4)</u></b>				
	<b><u>Lintels</u></b>				
d	230 x 150mm Rectangular lintel reinforced with 4 No. 12mm diameter mild steel bars, 8mm diameter mild steel stirrups at 300mm centres and finished rough all round	119	M	10,500	1,249,500
	To Collection				7,193,914

EMD/ICU- 6



ITEM	DESCRIPTION	QTY	UNIT	RATE	AMOUNT
	<u>Cills</u>				
a	280 x 80mm; weathered once; throated once; reinforced 4 No. 12mm rolled mild steel bars; 8mm diameter mild steel links at 250mm centres; finish fair on top, two faces and part soffits;	148	M	11,000	1,628,000
	<u>Pre cast concrete grade "25" louver block BS 2028 type "A" bedded and jointed in cement mortar (1:4)</u>				
b	200mm Wall built fair and flush (for waiting area, medical gas and power room)	167	M <sup>2</sup>	30,000	5,010,000
c	Raking cutting; 230mm block wall	37	M	5,000	185,000
d	Materials in eaves filling; 230mm wide; 500mm high extreme including splay cutting;	84	M	8,500	714,000
	To collection				7,537,000
	<b>COLLECTION</b>				
	Page 5				65,426,000
	Page 6				7,193,914
	Page 7				7,537,000
	<b>TOTAL SUPERSTRUCTURE TO SUMMARY TSHS</b>				<b>80,156,914</b>



ITEM	DESCRIPTION	QTY	UNIT	RATE	AMOUNT
	<u>ELEMENT No. 3- DOORS</u>				
	<u>Joinery</u>				
	<u>Solid Core Flush Door to meet manufacturers' requirements as approved by the Project Manager</u>				
	<u>Flush doors</u>				
	<u>40mm thick Solid Core Flush Door; equally divided, comprising on both sides; 150mm metal kick plate at the bottom; 125mm metal bumper plate at the intermediate; top panel with slit having 6mm thick clear sheet glass faced both sides; styles and rails with approved hardwood timber quality; 4mm exterior quality plywood; 12mm hardwood lipping glued with approved adhesives, pinned on all edges to Project Manager's instructions</u>				
a	Ditto; Door size 1500x2500mm; Double Swing with SLIT 3	12	No	575,000	6,900,000
b	Ditto; Door size 2000x3000mm; Double Swing with SLIT 3	1	No	900,000	900,000
c	Ditto; Door size 900x2500mm; Double Swing with SLIT 3	4	No	337,500	1,350,000
d	Ditto; Door size 1000x2500mm	1	No	375,000	375,000
e	Ditto; Door size 900x2500mm; ditto	34	No	337,500	11,475,000
	To Collection				21,000,000

EMD/ICU- 8



10



ITEM	DESCRIPTION	QTY	UNIT	RATE	AMOUNT
	<u>Frames and the like; Prime Quality sawn hardwood Mninga or Mkongo; door frames, transoms with one labour; fillets, glazing and grounds;</u>				
a	45 x 150mm Frame	430	M	25,000	10,750,000
b	45 x 150mm Transome	66	M	25,000	1,650,000
c	45 x 150mm Mullions	52	M	25,000	1,300,000
d	15 x 45mm Moulded Architrave	894	M	2,500	2,235,000
e	40 x 15mm Sprayed glazing beads	208	M	3,600	748,800
f	15 x 100mm Grounds, plugged	160	M	4,000	640,000
	<u>Glazing</u>				
	<u>5mm Thick polished clear plate glass</u>				
g	Panes over 0.10 but not exceeding 0.50 square metres	42	M <sup>2</sup>	28,000	1,176,000
	<u>Ironmongery</u>				
	<u>Supply and fix the following Iron mongery as per HAFELE or any other equal and approved quality fixed with screws to hardwood timber</u>				
h	Three levers mortise lockset complete with furniture	52	No	85,000	4,420,000
g	Toilet mortise lockset; indicator bolts or any other equal and approved quality; complete with furniture	8	No	20,000	160,000
h	150x75mm Aluminium stainless steel brass butt hinges	156	Prs	15,000	2,340,000
j	38mm diameter, rubber floor mounted door stopper	44	No	10,000	440,000
	To Collection				25,859,800

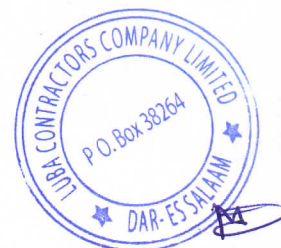

ITEM	DESCRIPTION	QTY	UNIT	RATE	AMOUNT
a	Automatic Overhead door closer	39	No	80,000	3,120,000
b	Hydraulic door closer hinges for double swing door	14	No	150,000	2,100,000
c	Name plates on doors; 'Gibbons' card holder with side entry; sample to be approved	52	No	15,000	780,000
d	Signage to all potential areas; to be identified by users; (sample to be approved).	52	No	15,000	780,000
<b><u>METAL WORKS</u></b>					
<b><u>Supply and fix mild steel grille comprising of Rectangular hollow section 38 x 38mm framing, 5 x 40mm flat bar welded to framing at 148mm centre cross grid to an approved pattern; complete with rust resistant hardware; including fixing to concrete or block work;</u></b>					
e	Ditto; Door size 900x3000mm (For Secretary door, payment office, dispensing, Medical gas and Power room)	6	No	256,500	1,539,000
	To Collection				8,319,000
<b>COLLECTION</b>					
	Page 8				21,000,000
	Page 9				25,859,800
	Page 10				8,319,000
<b>TOTAL DOORS TO SUMMARY</b>					<b>55,178,800</b>



ITEM	DESCRIPTION	QTY	UNIT	RATE	AMOUNT
	<u>ELEMENT No. 4- WINDOWS</u>				
	<u>ALUMINIUM WORKS</u>				
	<u>Supply and fix 100mm Natural Anodized Aluminium framing to pattern; neoprene gasket for bedding nylon brusher at the head; and rails and stainless screws approved by the Project Manager, including mosquito gauze and 6mm thick single glazed glass (either clear or frosted glass as shall be determined by the location usage); bedding in approved compound and fixing to concrete background; including all necessary accessories, ironmongery, cutting and pinning lugs and bedding frame in cement mortar</u>				
	<i>(Note: To be executed by the Proven Specialist Contractor)</i>				
a	Window size 1600 x 1250mm overall height	24	No	285,000	6,840,000
b	Window size 1200 x 1500mm overall height	12	No	275,000	3,300,000
c	Window size 900 x 900mm overall height	6	No	115,000	690,000
d	Window size 1800 x 1200mm overall height	18	No	315,000	5,670,000
e	Window size 2400 x 1500mm overall height	1	No	540,000	540,000
	To Collection				17,040,000

EMD/ICU- 11



ITEM	DESCRIPTION	QTY	UNIT	RATE	AMOUNT
	<b><u>METAL WORKS</u></b>				
	<u>Supply and fix mild steel grille comprising of Rectangular hollow section 38 x 38mm framing, 5 x 40mm flat bar welded to framing at 148mm centre cross grid to an approved pattern; complete with rust resistant hardware; including fixing to concrete or block work;</u>				
a	size 1500 x 1500mm overall height	19	No	202,000	3,838,000
b	size 1200 x 2000mm overall height	4	No	215,000	860,000
c	size 900 x 900mm overall height	7	No	72,950	510,650
	To Collection				5,208,650
	<b>COLLECTION</b>				
	Page 11				17,040,000
	Page 12				5,208,650
	<b>TOTAL WINDOWS TO SUMMARY</b>				<b>22,248,650</b>

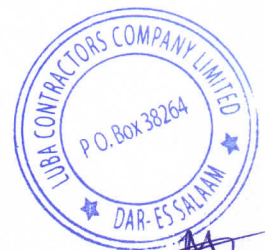

ITEM	DESCRIPTION	QTY	UNIT	RATE	AMOUNT
	<u>ELEMENT No. 5- ROOFING</u>				
	<u>Roof covering</u>				
	<u>Roofing; 28 gauge pre-painted green or any approved Colour with Resin Coated IT 5 troughed AluZinc sheets; single length; supplied by Aluminium Africa Ltd. or equal and approved; fixed in accordance with the manufacturer's printed instructions</u>				
a	Coverings; flat or sloping not exceeding 45 degrees from horizontal; fixing to timber at 500mm general spacing with 16 Gauge galvanized roofing nails complete with galvanized steel and bituminous washers	953	M2	19,000	18,107,000
	<u>Accessories in Gauge 28 Resin Colour coated Aluminium sheet to match roofing, fixing with drive screws to sheeting;</u>				
b	ridge capping; 550mm girth; three times bent; nailed to battens, twice fixed at 450mm centres	81	M	10,500	850,500
c	hip capping; 550mm girth; three times bent; nailed to battens, twice fixed at 450mm centres	56	M	10,500	588,000
d	valley gutter; 550mm girth; three times bent; nailed to battens, twice fixed at 450mm centres	43	M	10,500	451,500
	To Collection				19,997,000



ITEM	DESCRIPTION	QTY	UNIT	RATE	AMOUNT
	<u>Roof structure</u>				
	<u>Sawn softwood pressure impregnated with preservative</u>				
a	50 x 150mm Rafter	1,607	M	4,500	7,231,500
b	50 x 150mm Ceiling joist, king posts, & struts.	2,215	M	4,500	9,967,500
c	50 x 75mm Valley rafter	65	M	2,750	178,750
d	50 x 100mm Wall plates	625	M	3,000	1,875,000
e	50 x 75mm Purlins	1,096	M	2,750	3,014,000
f	50 x 100mm Members of roof truss	142	M	3,000	426,000
	<u>Carpenter's metal work</u>				
g	R4	36	Pcs	6,000	216,000
	To Collection				22,908,750

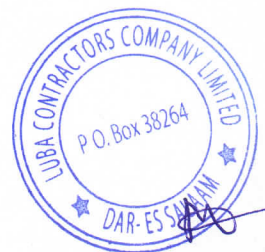

ITEM	DESCRIPTION	QTY	UNIT	RATE	AMOUNT
	<u>Roof Water Slab water-proofing &amp; flat roof areas</u>				
	<u>Tropical High performance Approved by the Project Manager roofing felt; First layer Tropical V; Second layer Tropical TNT; finished with aluminium paint; all laid by an approved specialist in accordance with manufacturers printed instructions (To be done by a Specialist)</u>				
a	two layer covering; over 300mm girth; to falls or cross falls or sloping not exceeding 45 degrees from horizontal	57	SM	25,000	1,425,000
	<u>Rainwater installation; pipe work; PLASCO-UPVC pipes and fittings; heavy grade; painted on site</u>				
b	125mm diameter half round PVC Rainwater gutter; ring seal joints in the running length; plastic holder bats; fixing to backgrounds requiring plugging	28	No	45,000	1,260,000
c	Ditto; 75mm down pipe	8	No	35,000	280,000
d	Gutter support bracket	36	No	3,000	108,000
e	Extra; clamp 3"	168	No	6,000	1,008,000
f	Connector outlet	6	No	6,000	36,000
g	Elbow	6	No	9,000	54,000
h	Angle	12	No	6,000	72,000
	<u>Impregnated Treated softwood timber or other equal and approved hardwood</u>				
j	20 x 250mm Fascia board	203	LM	6,500	1,319,500
	To Collection				5,562,500

EMD/ICU- 15



Handwritten signature or initials.

ITEM	DESCRIPTION	QTY	UNIT	RATE	AMOUNT
	COLLECTION				
	Page 13				19,997,000
	Page 14				22,908,750
	Page 15				5,562,500
	Page 16				5,562,500
	TOTAL ROOFING TO SUMMARY				54,030,750





ITEM	DESCRIPTION	QTY	UNIT	RATE	AMOUNT
	<b>ELEMENT NO.6- FINISHINGS</b>				
	<u>15mm Thick plaster 1:4 to internal walls, roof slab, sides and soffities of beams, columns and the like</u>				
a	cement - 50 Kgs 42.5	280	Bags	19,000	5,320,000
b	sand for mortar	10	Trips	90,000	900,000
	<u>15mm thick Rendering to walls (1:4)</u>		cm		
c	cement - 50 Kgs 42.5	124	Bags	19,000	2,356,000
d	sand for mortar	4	Trip	90,000	360,000
	<u>Wall Tiles</u>				
	<u>12mm thick wall tiles bedding mortar 1:4:</u>				
e	cement - 50 Kgs 42.5	44	Bags	19,000	836,000
f	sand for mortar	2	Trip	90,000	135,000
	<u>White glazed ceramic wall tiles with cushion edges to BS 1282 fixed to backing with adhesive and pointed with white grout</u>				
h	200 x 300 x 6mm Tiling to walls	220	M <sup>2</sup>	35,000	7,700,000
j	cement - 50 Kgs 42.5	15	bags	19,000	285,000
*k	sand for mortar	0.4	Trips	90,000	36,000
	To Collection				17,928,000

EMD/ICU- 17



ITEM	DESCRIPTION	QTY	UNIT	RATE	AMOUNT
	<u>Tiles, slab or block finishings</u>				
	<u>Coloured porcelain non slippery/non-glazed floor tiles or other equal and approved with cushion edges fixed to screed with adhesive and pointed with coloured grout</u>				
a	500 x 500 x 12mm Tiling to floors	1,097	M <sup>2</sup>	45,000	49,365,000
b	2.5mm skirting 150mm high with splayed edge	568	M	4,000	2,272,000
c	cement - 50 Kgs 42.5	230	bags	19,000	4,370,000
d	sand for mortar	7	Trips	90,000	630,000
	<u>Allow for EPOXY finishings as per project Manager's instructions</u>				
e	Epoxy Floor finish to operating rooms	24	M <sup>2</sup>	130,000	3,120,000
f	2.5mm skirting 150mm high with splayed corner	20	M	10,000	200,000
	<u>Ceiling finish</u>				
g	9mm Gypsum ceiling (Thailand)	364	Pcs	19,000	6,916,000
h	Cornices (plain)	385	Pcs	5,000	1,925,000
j	50x50mm Treated softwood bandering	1,167	Pcs	4,000	4,668,000
k	Assorted nails	30	Kgs	3,500	105,000
l	Gypsum powder	60	Bags	18,500	1,110,000
m	Fibre tape	42	Roll	10,000	420,000
n	Gypsum screws	42	Boxes	10,000	420,000
	To Collection				75,521,000

EMD/ICU- 18



ITEM	DESCRIPTION	QTY	UNIT	RATE	AMOUNT
a	Extra; access panels; Local Fundi designed dimensions; pre-drilled fixed with screws, plastic sockets and cups as per project manager's instructions	1	No	30,000	30,000
	<u>To Collection</u>				30,000
	<u>COLLECTION</u>				
	Page 18				17,928,000
	Page 19				75,521,000
	Page 20				30,000
	<b>TOTAL FINISHING TO SUMMARY</b>				<b>93,479,000</b>



ITEM	DESCRIPTION	QTY	UNIT	RATE	AMOUNT
	<b>ELEMENT NO.7- PAINTINGS AND DECORATIONS</b>				
	<u>Prepare and apply one thinned coat and two full coats of wash 'n' ware paint to plastered walls, sloping soffities of stair cases, ceiling, gypsum ceiling</u>				
a	Wash 'n' ware paint	45	Bucket	160,000	7,200,000
	<u>Prepare silicon based paint and apply one thinned coat of acrylic primer; one coat of STUCCO surface and one finishing coat of EPOXY finished paint onto:</u>				
b	Plastered walls; in the theatre room, treatment room and resuscitation rooms	393	SM	20,000	7,860,000
	<u>External work</u>				
	<u>Prepare and apply one primer coat and two finishing coats of Galaxy weather guard paint or other equal and approved</u>				
c	Weather guard paints	12	Bucket	160,000.00	1,920,000
d	White Cement	22	Bags	40,000.00	880,000
e	Gloss oil paints	12	Tin	25,000.00	300,000.00
f	Undercoat	60	Bucket	35,000.00	2,100,000.00
	<b>TOTAL DECORATION TO SUMMARY</b>				<b>20,260,000</b>



ITEM	DESCRIPTION	QTY	UNIT	RATE	AMOUNT
	<p><b>ELEMENT No. 8- PLUMBING AND ENGINEERING INSTALLATIONS (Provisional)</b></p> <p><u>Sanitary installations</u></p> <p><u>Supply and fix the following sanitary appliances, Armitage Shanks references, including all connections and fixing to floor or wall where necessary</u></p>				
a	<p>480 x 420mm White vitreous china Tempo 48 Hand Wash Basin countertop single central tapless basin monoblock mixer with pop up waste, 32mm chrome plated metal bottle trap with 75mm seal, concealed brackets with fixing clamps in aluminium alloy and isovalve.</p>	20	No	450,000	9,000,000
b	<p>Western Type White vitreous WC suite to BS 3402 complete with horizontal outlet flush valve cistern 6 litre, plastic seat cover, S or P or Turned P trap; bottom supply and internal overflow domex screws; including all necessary accessories and connection to drain pipe.</p>	5	No	500,000	2,500,000
c	<p>Standard Disabled Western Type, back to wall WC in White vitreous WC to BS 3402 complete with horizontal outlet flush valve cistern 6 litre, plastic seat cover, S or P or Turned P trap; bottom supply and internal overflow domex screws; including all necessary accessories and connection to drain pipe</p>	2	No	2,500,000	5,000,000
	To Collection				16,500,000



ITEM	DESCRIPTION	QTY	UNIT	RATE	AMOUNT
a	Asian Type Squatting White vitreous low level WC suite to BS 3402 complete with horizontal outlet flush valve cistern 6 litre, bottom supply and internal overflow domex screws and S-trap	2	No	250,000	500,000
b	Standard Stainless Steel Scrub Sink for Surgical theatre room; complete with all accessories	1	No	650,000	650,000
c	Standard Stainless Steel Sluice Trough for Surgical theatre room; complete with all accessories	1	No	1,500,000	1,500,000
d	Vitreous china toilet roll holder (S5005 - 2076100) with shelf, screwed to wall	7	No	30,000	210,000
e	Wall mounted tissue paper Dispenser	8	No	80,000	640,000
f	Mirror, special quality plate glass size 500 x 1000 x 6 mm thick with silver resistant coating on side, fixing with domex screws to background requiring plugging	7	No	80,000	560,000
	<u>Sundries</u>				
g	Allow Provisional sum plumbing accessories and pipe works	1	PS	12,000,000	12,000,000
h	Allow cost for Medical Gas installation as per project Manager's instructions	1	PS	32,500,000	32,500,000
j	Allow cost for ICT installation as per project Manager's instructions	1	PS	11,000,000	11,000,000
	To collection				59,560,000



ITEM	DESCRIPTION	QTY	UNIT	RATE	AMOUNT
	COLLECTION				
	Page 20				16,500,000
	Page 21				59,560,000
	TOTAL PLUMBING TO SUMMARY				76,060,000



ITEM	DESCRIPTION	QTY	UNIT	RATE	AMOUNT
<b>GENERAL SUMMARY</b>					
1	Substructure				117,258,743
2	Superstructure				80,156,914
3	Doors				55,178,800
4	Windows				17,040,000
5	Roofing				54,030,750
6	Finishings				93,479,000
7	Decorations				20,260,000
8	Plumbing and Engineering Installations				76,060,000
	Sub total		Tshs.		513,464,207
	Add: Electrical Installations			Sum	16,050,000
	Sub total				529,514,207
	Add: 25% labour charges				132,378,552
	Add: 1% transport charges				5,295,142
	Sub total				667,187,901
	Add: Preliminary works (Includes Water for the works, removing rubbish and cleaning, tools, plants and Scaffolding, Site accomodation, Watching and Lighting, Testing, etc)				12,500,000
	Add: Direct Labour cost				3,646,500
	<b>GRAND TOTAL</b>		Tshs.		<b>683,334,401</b>

*Imwagdas*



*MD*



# DRAWINGS

PROPOSED CONSTRUCTION OF EMERGENCY MEDICAL  
DEPARTMENT (EMD) FOR GENERAL REFERRAL  
HOSPITAL.

ELECTRICAL, FIRE ALARM SYSTEM, ICT SERVICES DRAWINGS  
AND  
MECHANICAL SERVICES DRAWINGS

CLIENT:

MINISTRY OF HEALTH, COMMUNITY  
DEVELOPMENT, GENDER, ELDERLY AND CHILDREN,



# PROPOSED CONSTRUCTION OF EMERGENCY MEDICAL DEPARTMENT (EMD) FOR GENERAL REFERRAL HOSPITAL, ELECTRICAL LEGEND AND GENERAL NOTES

ELECTRICAL LEGEND	MOUNTING HEIGHT(mm)	GENERAL NOTES:
1.  B — LIGHT FITTING TYPE B (SUSPENDED) TYPE LIGHTING, DOWN SURFACE, WITH FINISH OF SURFACE SECTION AS SHOWN. TYPE OF FINISH TO BE SPECIFIED.	CEILING	<p><b>GENERAL NOTES:</b></p> <ol style="list-style-type: none"> <li>THE ELECTRICAL INSTALLATIONS SHALL COMPLY WITH IEE WIRING REGULATIONS 17<sup>TH</sup> EDITION BS 7671 2008 WITH CLASSED APPLIANCE AND CONSUMER UNITS, BY LAWS AND REGULATIONS.</li> <li>THE ELECTRICAL INSTALLATIONS SHALL COMPLY WITH IEE WIRING REGULATIONS 17<sup>TH</sup> EDITION BS 7671 2008 WITH CLASSED APPLIANCE AND CONSUMER UNITS, BY LAWS AND REGULATIONS.</li> <li>THE ELECTRICAL INSTALLATIONS SHALL BE DESIGNED NOT USING PVC INSULATED COPPER CABLES DRAWN INTO CONCEALED CONDUITS, SHALL TRAY, TRUNKING AND DUCTS.</li> <li>SOCKET OUTLET, TV OUTLETS AND TELEPHONE POINTS SHALL BE MOUNTED AT 200mm AFFL.</li> <li>ALL WIRING ACCESSORIES SHALL BE MOUNTED ON STEEL BOXES OF PVC BOXES ARE NOT ACCEPTABLE.</li> <li>DP SWITCHES AND LIGHTING SWITCHES SHALL BE MOUNTED AT 1400mm AFFL.</li> <li>EVMS SHALL HAVE A 20A DP SWITCH MOUNTED CLOSE TO THE FLOOR UNIT AT LEAST 0.5M ABOVE THE FLOOR LEVEL.</li> <li>THE NUMBER OF EARTH ROSES TO BE DETERMINED BY SOLICITORS/ENGINEER SUCH THAT CONSUMER BURN ELECTRODE RESISTANCE SHALL NOT EXCEED 2 OHMS.</li> <li>DISTRIBUTION BOARD/CONSUMER UNIT SHALL BE INSTALLED AT 2000mm AFFL.</li> <li>ALL M.C.B.'S, SWITCH SOCKETS OUTLETS, DP SWITCHES AND LIGHT SWITCHES SHALL BE CLEARLY MARKED TO INDICATE THE CIRCUIT NUMBERS AS SHOWN IN DRAWINGS.</li> <li>ALL LIGHTING FITTINGS SHALL BE SUPPLIED COMPLETE WITH LAMP'S OF CORRECT WATTAGE.</li> <li>THE SENSITIVITY OF THE RCD SHALL BE AS PER SPECIFICATIONS, AND OTHER RATING OTHER THAN THOSE SPECIFIED SHALL NOT BE ACCEPTED.</li> <li>NO MORE THAN ONE SUB-CIRCUIT CABLES SHALL BE INSTALLED IN ONE CONDUIT.</li> <li>SWITCHES OF DIFFERENT SIZE CIRCUITS SHALL BE MOUNTED ON THEIR OWN BOXES EXCEPT FOR GPO SWITCHES.</li> <li>ALL ELECTRICAL MATERIAL, OTHER THAN THOSE SPECIFIED SHALL BE SUBMITTED TO APPROVAL PRIOR TO PURCHASE/INSTALLATION.</li> <li>THE CONNECTION LINES FOR MAIN CIRCUITS AND LIGHTING POINTS ARE FOUR COLOURS ONLY. THE CONTRACTOR SHALL DETERMINE THE EXACT CONNECTION LINES TO BE USED ACCORDING TO THE TRIPPING/CONDUIT ROUTES ADVISED.</li> <li>ALL TELEPHONE OUTLETS INTERLINKED WITH 20mm DIA/TYPE PVC CONDUIT OPERATED FROM 25% POSITION. ENTRANCE LOCATION OF MAIN CABLE AND DISTRIBUTION UNIT TO BE DECIDED AT SITE.</li> </ol>
2.  C — WALL MOUNTED LIGHT FITTING TYPE C (DOWN SURFACE) TYPE LIGHTING, DOWN SURFACE, WITH FINISH OF SURFACE SECTION AS SHOWN. TYPE OF FINISH TO BE SPECIFIED.	WALL	
3.  D — DOWNLIGHT, DOWN SURFACE, WITH FINISH OF SURFACE SECTION AS SHOWN. TYPE OF FINISH TO BE SPECIFIED.	CEILING	
4.  E — EMERGENCY LIGHT, DOWN SURFACE, WITH FINISH OF SURFACE SECTION AS SHOWN. TYPE OF FINISH TO BE SPECIFIED.	CEILING	
5.  A — LIGHT FITTING TYPE A (DOWN SURFACE) TYPE LIGHTING, DOWN SURFACE, WITH FINISH OF SURFACE SECTION AS SHOWN. TYPE OF FINISH TO BE SPECIFIED.	1000 AFFL	
6.  B — LIGHT FITTING TYPE B (SUSPENDED) TYPE LIGHTING, DOWN SURFACE, WITH FINISH OF SURFACE SECTION AS SHOWN. TYPE OF FINISH TO BE SPECIFIED.	1000 AFFL	
7.  C — WALL MOUNTED LIGHT FITTING TYPE C (DOWN SURFACE) TYPE LIGHTING, DOWN SURFACE, WITH FINISH OF SURFACE SECTION AS SHOWN. TYPE OF FINISH TO BE SPECIFIED.	1000 AFFL	
8.  D — DOWNLIGHT, DOWN SURFACE, WITH FINISH OF SURFACE SECTION AS SHOWN. TYPE OF FINISH TO BE SPECIFIED.	1000 AFFL	
9.  E — EMERGENCY LIGHT, DOWN SURFACE, WITH FINISH OF SURFACE SECTION AS SHOWN. TYPE OF FINISH TO BE SPECIFIED.	300 AFFL	
10.  A — LIGHT FITTING TYPE A (DOWN SURFACE) TYPE LIGHTING, DOWN SURFACE, WITH FINISH OF SURFACE SECTION AS SHOWN. TYPE OF FINISH TO BE SPECIFIED.	300 AFFL	
11.  B — LIGHT FITTING TYPE B (SUSPENDED) TYPE LIGHTING, DOWN SURFACE, WITH FINISH OF SURFACE SECTION AS SHOWN. TYPE OF FINISH TO BE SPECIFIED.	300 AFFL	
12.  C — WALL MOUNTED LIGHT FITTING TYPE C (DOWN SURFACE) TYPE LIGHTING, DOWN SURFACE, WITH FINISH OF SURFACE SECTION AS SHOWN. TYPE OF FINISH TO BE SPECIFIED.	300 AFFL	
13.  D — DOWNLIGHT, DOWN SURFACE, WITH FINISH OF SURFACE SECTION AS SHOWN. TYPE OF FINISH TO BE SPECIFIED.	300 AFFL	
14.  E — EMERGENCY LIGHT, DOWN SURFACE, WITH FINISH OF SURFACE SECTION AS SHOWN. TYPE OF FINISH TO BE SPECIFIED.	300 AFFL	
15.  A — LIGHT FITTING TYPE A (DOWN SURFACE) TYPE LIGHTING, DOWN SURFACE, WITH FINISH OF SURFACE SECTION AS SHOWN. TYPE OF FINISH TO BE SPECIFIED.	300 AFFL	
16.  B — LIGHT FITTING TYPE B (SUSPENDED) TYPE LIGHTING, DOWN SURFACE, WITH FINISH OF SURFACE SECTION AS SHOWN. TYPE OF FINISH TO BE SPECIFIED.	300 AFFL	
17.  C — WALL MOUNTED LIGHT FITTING TYPE C (DOWN SURFACE) TYPE LIGHTING, DOWN SURFACE, WITH FINISH OF SURFACE SECTION AS SHOWN. TYPE OF FINISH TO BE SPECIFIED.	300 AFFL	
18.  D — DOWNLIGHT, DOWN SURFACE, WITH FINISH OF SURFACE SECTION AS SHOWN. TYPE OF FINISH TO BE SPECIFIED.	300 AFFL	
19.  E — EMERGENCY LIGHT, DOWN SURFACE, WITH FINISH OF SURFACE SECTION AS SHOWN. TYPE OF FINISH TO BE SPECIFIED.	300 AFFL	

NOTES:

NO.	REVISIONS

**PROJECT:**  
PROPOSED CONSTRUCTION OF EMERGENCY MEDICAL DEPARTMENT FOR GENERAL REFERRAL HOSPITAL.

**CLIENT:**  
MINISTRY OF HEALTH COMMUNITY DEVELOPMENT GENERAL REFERRAL AND CHILDREN.

**SERVICES DESIGNER:**  
MSOFFE, S. Z  
E-mail : smsdfe@gmail.com

**DRAWING TITLE:**  
ELECTRICAL LEGEND SYMBOLS AND GENERAL NOTES

S. No.	Date	From	To	By

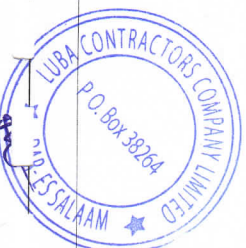

Drawing Number: MHEMD-E-01



NOTES:

NO.	DATE	REVISIONS

**PROJECT:**  
 PROPOSED CONSTRUCTION OF EMERGENCY MEDICAL DEPARTMENT (EMD) FOR GENERAL HOSPITAL HOSBAYT.

**CLIENT:**  
 MINISTRY OF HEALTH COMMUNITY DEVELOPMENT GENERAL CHILDREN.

**SERVICES DESIGNER:**  
 MSOFFE S. Z  
 E-mail : [smsoffe@gmail.com](mailto:smsoffe@gmail.com)

**DRAWING TITLE:**  
 FLOOR PLAN DEPTING LAYOUT PLAN

Scale:	Project:	Phase:	Issue:	Checked:
1:100	MS	MS	MS	ES

Drawn/Checked by: **MHEMIDI-02**



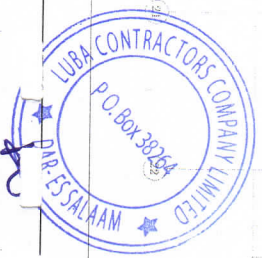

NOTES:

NO.	REVISION	DATE	BY

**PROJECT:**  
 PROPOSED CONSTRUCTION OF EMERGENCY MEDICAL REFERRAL UNIT FOR GENERAL REFERRAL (1000 B.E.D.)

**CLIENT:**  
 MINISTRY OF HEALTH/COMMUNITY DEVELOPMENT/GENERAL REFERRAL AND CHILDREN

**SERVICES DESIGNER:**  
 MSOFFE, S. Z  
 E-mail: smsoffe@gmail.com

**DRAWING TITLE:**  
 FLOOR PLAN POWER AND C.T. LAYOUT PLAN

Scale:	1:100	1:200	1:500	1:1000
Author:	M.S.	M.S.	M.S.	ES
Project Number:	MH/EMD/C-03			

FLOOR PLAN DISTRIBUTION BOARD SCHEMATIC

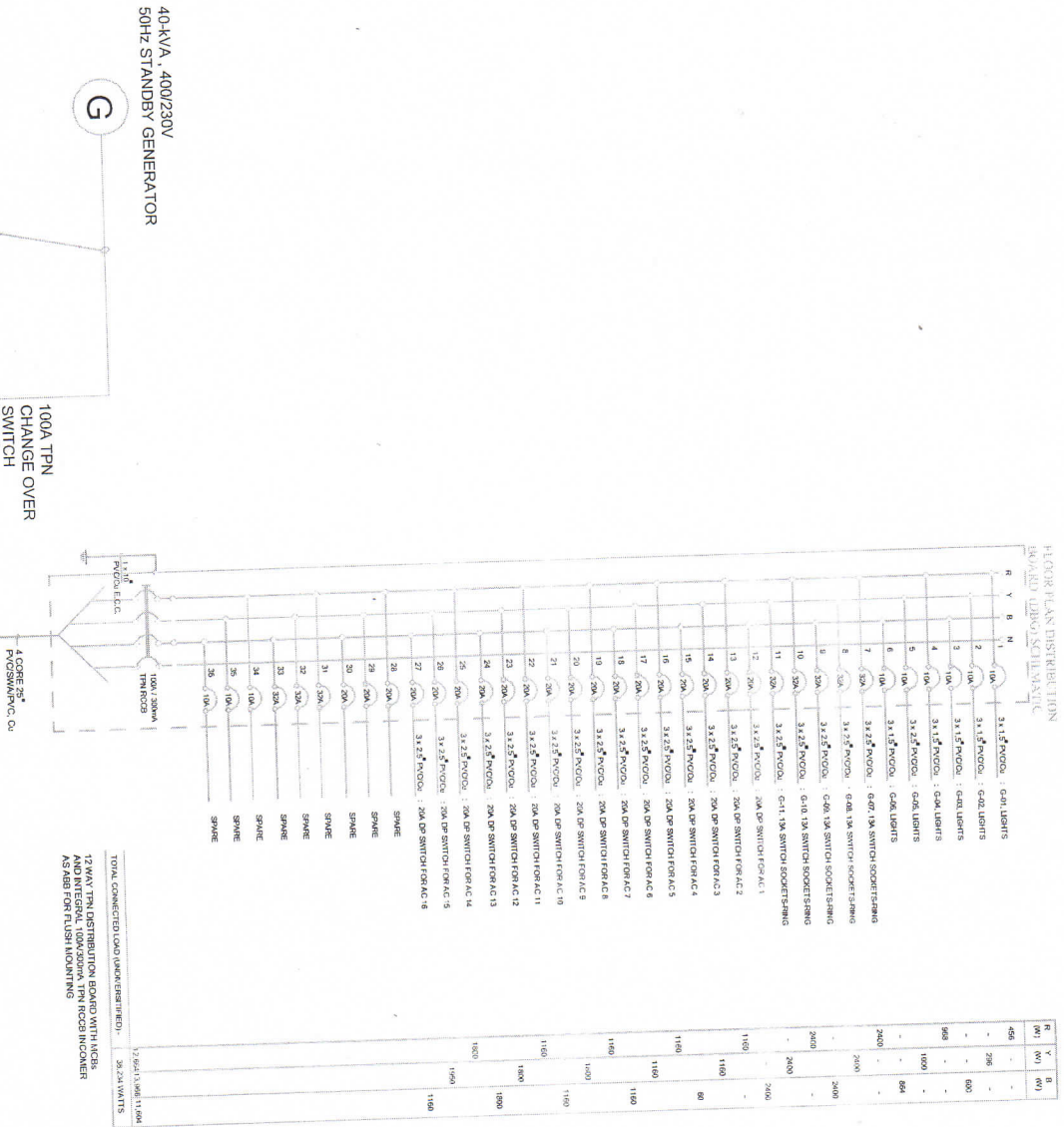

NOTES:

**PROJECT:**  
PROPOSED CONSTRUCTION OF EMERGENCY MEDICAL DEPARTMENT (EMD) FOR GENERAL REFERRAL HOSPITAL.

**CLIENT:**  
MINISTRY OF HEALTH, COMMUNITY DEVELOPMENT, FITNESS, KENYAN AND SPORTS.

**SERVICES DESIGNER:**  
MSOFFE, S. Z  
E-mail: smsoffe@gmail.com

**DRAWING TITLE:**  
DISTRIBUTION BOARD SCHEMATIC

Scale: 1:100

Drawn: M.S. / 11/2011  
Checked: E.S.

Project No: MHEMD/E-04

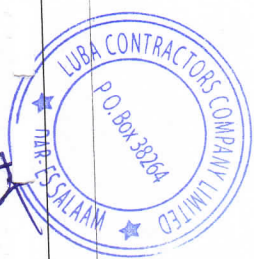

## FIRE DETECTION & ALARM SYSTEM LEGEND

S/No.	DESCRIPTION	SYMBOLS	MOUNTING
1.	Addressable fire control panel, Eurofire 3 loops, 6 zones as FEUR 6		1200mm AFFL
2	Optical Smoke detectors as Ode-OPT, Addressable complete with base		OCL
3	Breakglass Addressable, complete with surface -box as FML-200R		1400mm AFFL
4	Firebell/Addressable sounder, 6inch as ABB624		300mm BCL
5	Fireproof cable, 1.5mm square twin with earth in 20mm pvc conduit	NA	In conduit
6	Carbon dioxide cylinders 4.5kg complete with mounting brackets		1200mm AFFL
7	Dry powder cylinders, 4.5 kg, complete with mounting brackets		1200mm AFFL
8	Heat detectors as AP6-FT8 Addressable complete with base		OCL

**NOTE**

- AFFL - After Floor Finish Level
- BCL - Below Ceiling Level
- OCL - On Ceiling Level
- mm - Millimeter

## ADDRESSABLE FIRE ALARM CONTROL PANEL (FACP)

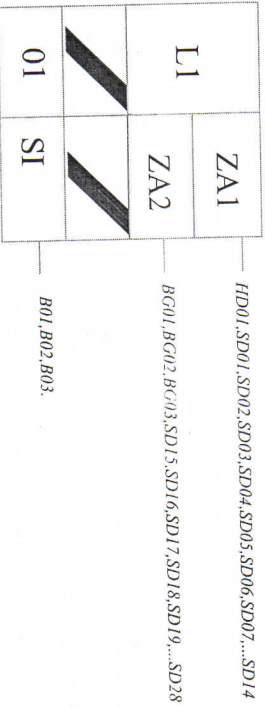

FIRE DETECTION AND ALARM PANEL SCHEMATIC (MP9308, 1 LOOPS, 2 ZONES FIRE PANEL C/W BATTERIES (72 HOUR STANDBY)

NOTES:

NO.	REV.	DATE	REVISION

**PROJECT:**  
 PROPOSED CONSTRUCTION OF EMERGENCY MEDICAL DEPARTMENT (EMERGENCY REFERRAL HOSPITAL)

**CLIENT:**  
 MINISTRY OF HEALTH/COMMUNITY DEVELOPMENT/GENERAL AND CHILDREN

**SERVICES DESIGNER:**  
 MSOFT S. Z  
 E-mail : smsdfe@gmail.com

**DRAWING TITLE:**  
 FIRE DETECTION AND ALARM SYSTEM LEGEND AND FIRE ALARM CONTROL PANEL

Drawing Number: **MH/EMD/E-05**



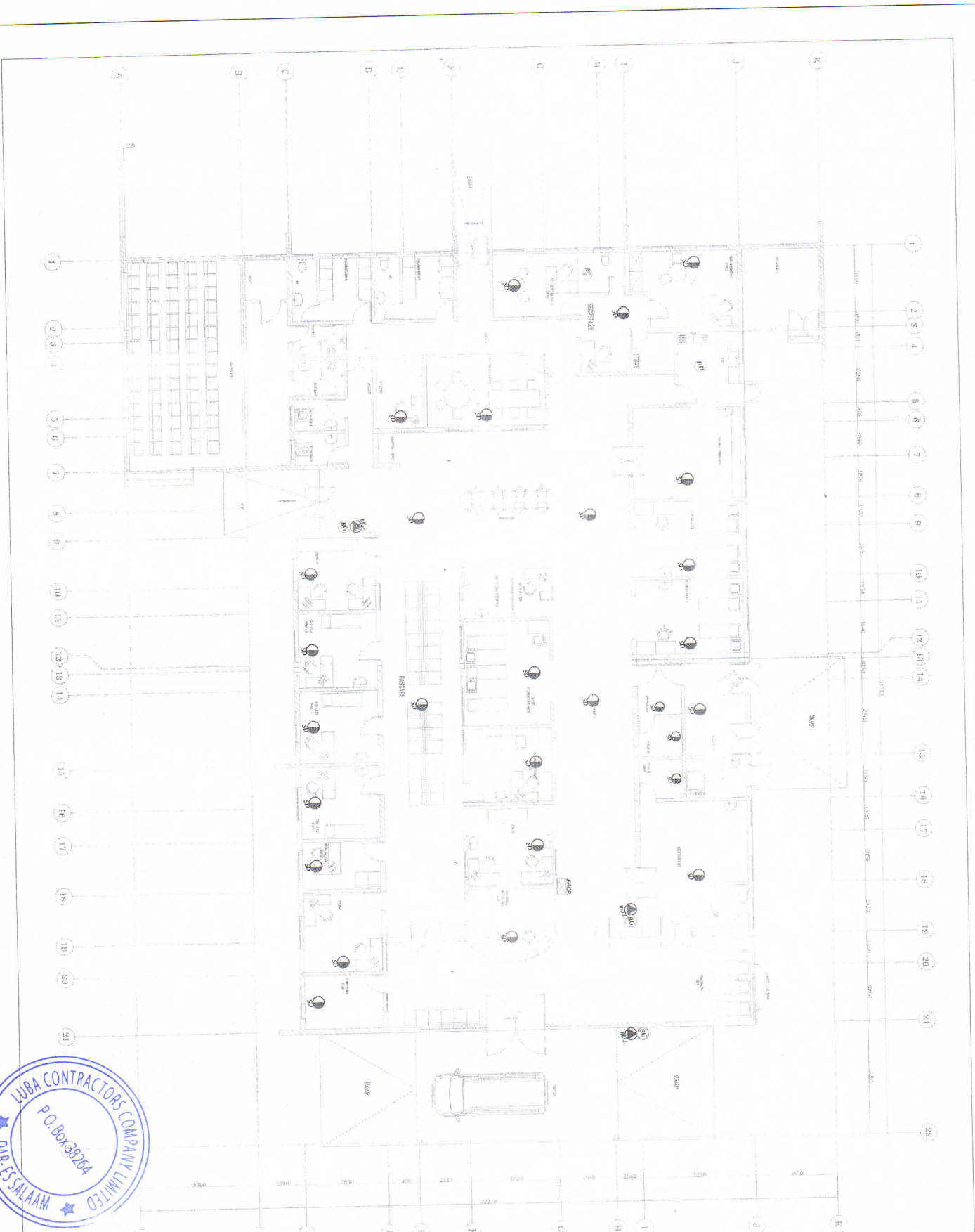

NOTES:

NO.	REVISIONS

**PROJECT:**  
 PROPOSED CONSTRUCTION OF EMERGENCY MEDICAL DEPARTMENT (EMD) FOR GENERAL REBERRAL HOSPITAL

**CLIENT:**  
 MINISTRY OF HEALTH, COMMUNITY DEVELOPMENT, GENDER, ELDERLY AND CHILDREN.

**SERVICES DESIGNER:**  
 MSOFFE, S. Z  
 E-mail : smsoffe@gmail.com

**DRAWING TITLE:**  
 FLOOR PLAN OF RECEPTION AND ADMIN SYSTEM LAYOUT PLAN

Scale:	1:100	1:100	1:100	1:100
Author:	MS	MS	MS	MS
Checked:	MS	MS	MS	MS
Date:	MS	MS	MS	MS



Drawing Number: MHEMD/E-06



# AIR CONDITION SERVICE LIST OF DRAWINGS

S/No.	DESCRIPTION	DRAWING No.	DATE/REV.
1	LIST OF DRAWINGS	MH/EMD/ME-AC/00	OCT, 2019
2	SYMBOLS, LEGEND & GENERAL NOTES & SCHEDULE OF EQUIPMENT	MH/EMD/ME-AC/01	OCT, 2019
3	AIR CONDITIONING EQUIPMENT & PIPING LAYOUT GROUND FLOOR PLAN	MH/EMD/ME-AC/02	OCT, 2019

NOTES:

NO.	DATE	BY	REVISIONS

**PROJECT:**  
PROPOSED CONSTRUCTION OF EMERGENCY MEDICAL DEPARTMENT (EMD) FOR GENERAL REFERRAL HOSPITAL.

**CLIENT:**  
MINISTRY OF HEALTH, COMMUNITY DEVELOPMENT, GENDER, ELDERLY AND CHILDREN.

**SERVICES DESIGNER:**  
PATRICIA D. S.  
E-mail : jdshtygo@gmail.com

**DRAWING TITLE:**  
LIST OF DRAWINGS AIR CONDITIONING

Scale:	Drawn:	Checked:	Comm.:
1:1	JDS		
Author:	Project S.	Project S.	Comm. S.
JDS			
Drawing Number: MH/EMD/ME-AC-00			



NOTES:

## GENERAL NOTES

1. INSTALLATION OF EQUIPMENT AND FITTINGS SHALL BE CARRIED OUT BY APPROVED CONTRACTOR TO RELEVANT CODES OF PRACTICE STANDARDS AND ACCORDANCE WITH MANUFACTURERS SPECIFICATIONS.
2. REFRIGERANT PIPES SHALL BE DEOXIDIZED PHOSPHOROUS SEAMLESS COPPER OR EQUIVALENT CONFORMING BS 2771-72
3. REFRIGERANT PIPES SHALL BE INSULATED AS RECOMMENDED BY MANUFACTURER.
4. INSULATION MATERIALS SHALL BE CHEMICAL GROSS LINKED THICKNESS 13mm.
5. PIPE WORK SHALL FOLLOW THE HORIZONTAL LINES OF SPACE PROVIDED IN THE CEILING VOID AND VERTICAL ALONG SHAFTS, PROPER PROTECTIVE SLEEVE SHALL BE PROVIDED WHERE PIPES RUN WALLS AND SLAB
6. CONDENSATE WATER DISPOSAL PIPE SHALL BE RIGID PVC OR EQUIVALENT AND SHALL BE INSULATED BY MATERIALS AS SPECIFIED AND THICKNESS NOT LESS THAN 6mm.
7. POSITION OF UNITS AND ROUTE FOR TRUNKING ARE FOR GUIDANCE ONLY EXACT POSITIONS AND ROUTES SHALL BE AGREED ON SITE.
8. ALL NECESSARY SUSPENSION BOLTS AND BRACKETS SHALL BE INCLUDED.
9. ELECTRICAL INSTALLATION SHALL BE CARRIED OUT BY APPROVED CONTRACTOR AND IN ACCORDANCE WITH IEEE REGULATIONS.

S/N	DESCRIPTION	SYMBOL	QUANTITY	UNIT	POWER SUPPLY	POWER RATING
1	Refrigerant pipe (mm)		1000	m	220V/50Hz	10
2	Refrigerant pipe (mm)		1000	m	220V/50Hz	10
3	Refrigerant pipe (mm)		1000	m	220V/50Hz	10
4	Refrigerant pipe (mm)		1000	m	220V/50Hz	10
5	Refrigerant pipe (mm)		1000	m	220V/50Hz	10
6	Refrigerant pipe (mm)		1000	m	220V/50Hz	10
7	Refrigerant pipe (mm)		1000	m	220V/50Hz	10
8	Refrigerant pipe (mm)		1000	m	220V/50Hz	10
9	Refrigerant pipe (mm)		1000	m	220V/50Hz	10
10	Refrigerant pipe (mm)		1000	m	220V/50Hz	10

**SYMBOLS:**

- Remote control
- Condensate water disposal pipe as specified
- Refrigerant pipes, as specified

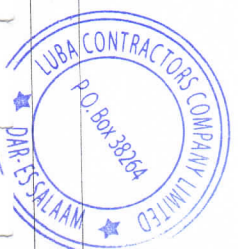

**PROJECT:**  
PROPOSED CONSTRUCTION OF EMERGENCY MEDICAL DEPARTMENT FOR GENERAL REFERRAL HOSPITAL.

**CLIENT:**  
MINISTRY OF HEALTH/COMMUNITY DEVELOPMENT/GENDER/ELDERLY AND CHILDREN.

**SERVICES DESIGNER:**  
PATRICIA D. S.  
E-mail : pstshayo@gmail.com

**DRAWING TITLE:**  
LIST OF LEGEND, SYMBOLS AND GENERAL NOTES

Scale: 1:1000

Revision: 1

Drawn by: MHE/MD/ME/C-01

**FLOOR PLAN**

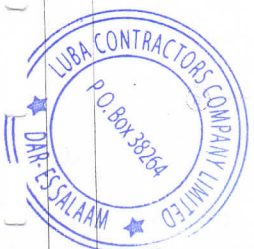
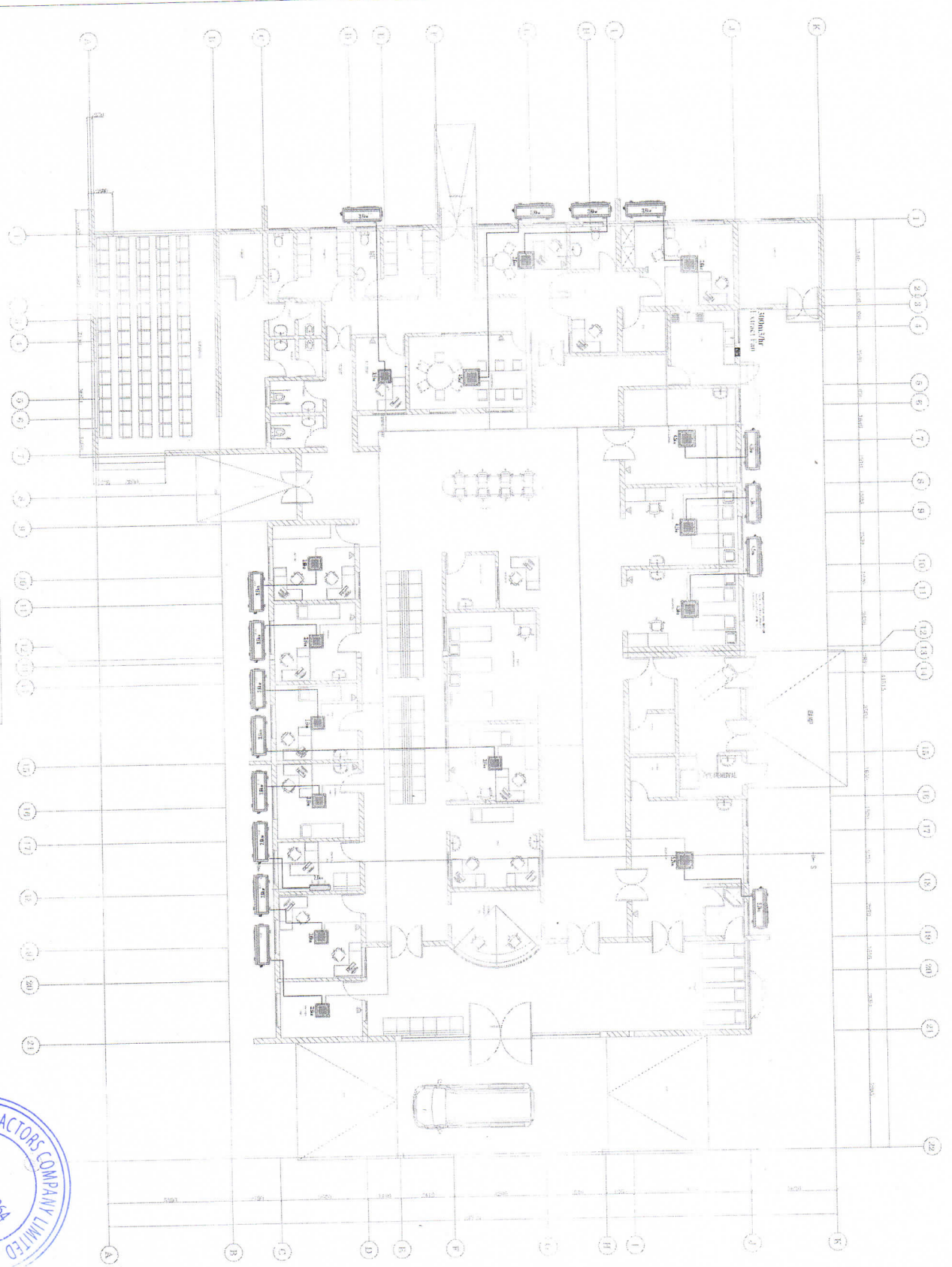

NOTES:

NO.	DATE	REVISION

**PROJECT:**  
 PROPOSED CONSTRUCTION OF EMERGENCY  
 MEDICAL DEPARTMENT (EMD) FOR  
 GENERAL REFERRAL HOSPITAL.

**CLIENT:**  
 MINISTRY OF HEALTH/COMMUNITY  
 DEVELOPMENT/GENDER ELDERLY  
 AND CHILDREN

**SERVICES DESIGNER:**  
 PATRICIA D. S.  
 E-mail - pds1stavo@gmail.com

**DRAWING TITLE:**

GROUND FLOOR AIR CONDITIONING LAYOUT

Scale:	Author:	Checker:	Project:	Sheet:

Drawn by: MHEM/ME/AC-02

# GAS SERVICE LIST OF DRAWINGS

S/No.	DESCRIPTION	DRAWING No.	DATE/REV.
1	LIST OF DRAWINGS	MH/EMD/GS-00	OCT, 2019
2	SYMBOLS, LEGEND & GENERAL NOTES & SCHEDULE OF EQUIPMENT	MH/EMD/GS-01	OCT, 2019
3	MEDICAL GAS INSTALLATION EQUIPMENT & PIPING LAYOUT GROUND FLOOR PLAN	MH/EMD/GS-02	OCT, 2019

NOTES:

REVISIONS

**PROJECT:**

PROPOSED CONSTRUCTION OF EMERGENCY MEDICAL DEPARTMENT (EMD) FOR GENERAL REFERRAL HOSPITAL.

**CLIENT:**

MINISTRY OF HEALTH, COMMUNITY DEVELOPMENT, GENDER, ELDERLY AND CHILDREN.

**SERVICES DESIGNER:**

PATRICIA D. S.  
E-mail : pds@yahoo@gmail.com

**DRAWING TITLE:**

LIST OF DRAWINGS GAS INSTALLATION

Drawn by:	Checked by:	Approved by:	Scale:
MH/EMD/GS-00			

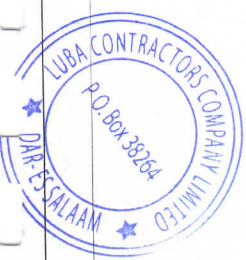

# LEGEND

 OXYGEN TERMINAL.

 NITROUS OXIDE TERMINAL.

 MEDICAL AIR TERMINAL.

 VACUUM TERMINAL.

 OXYGEN MED GAS LINE VALVE.

 NITROUS OXIDE MED GAS LINE VALVE

 MED AIR 4 BAR LINE VALVE

 VACUUM MED LINE VALVE

 LPG NON RETURN VALVE.

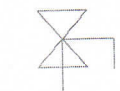
 LPG QUARTER TURN VALVE.

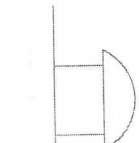
 PANIC SHUTOFF VALVE.

 LPG REGULATOR

NOTES:

REVISIONS

PROJECT:

PROPOSED CONSTRUCTION OF EMERGENCY MEDICAL DEPARTMENT FOR GENERAL REFERRAL HOSPITAL

CLIENT:

MINISTRY OF HEALTH, COMMUNITY DEVELOPMENT, GENDER, ELDERLY AND CHILDREN

ENGINEER:

PATRICIA D. S.  
E-mail : pdshayo@gmail.com

DRAWING TITLE:  
LIST OF LEGEND, SYMBOLS AND GENERAL NOTES

Scale: 1:1000

DATE: 10/20/2011



MHE/MD/EGS-01

4 b

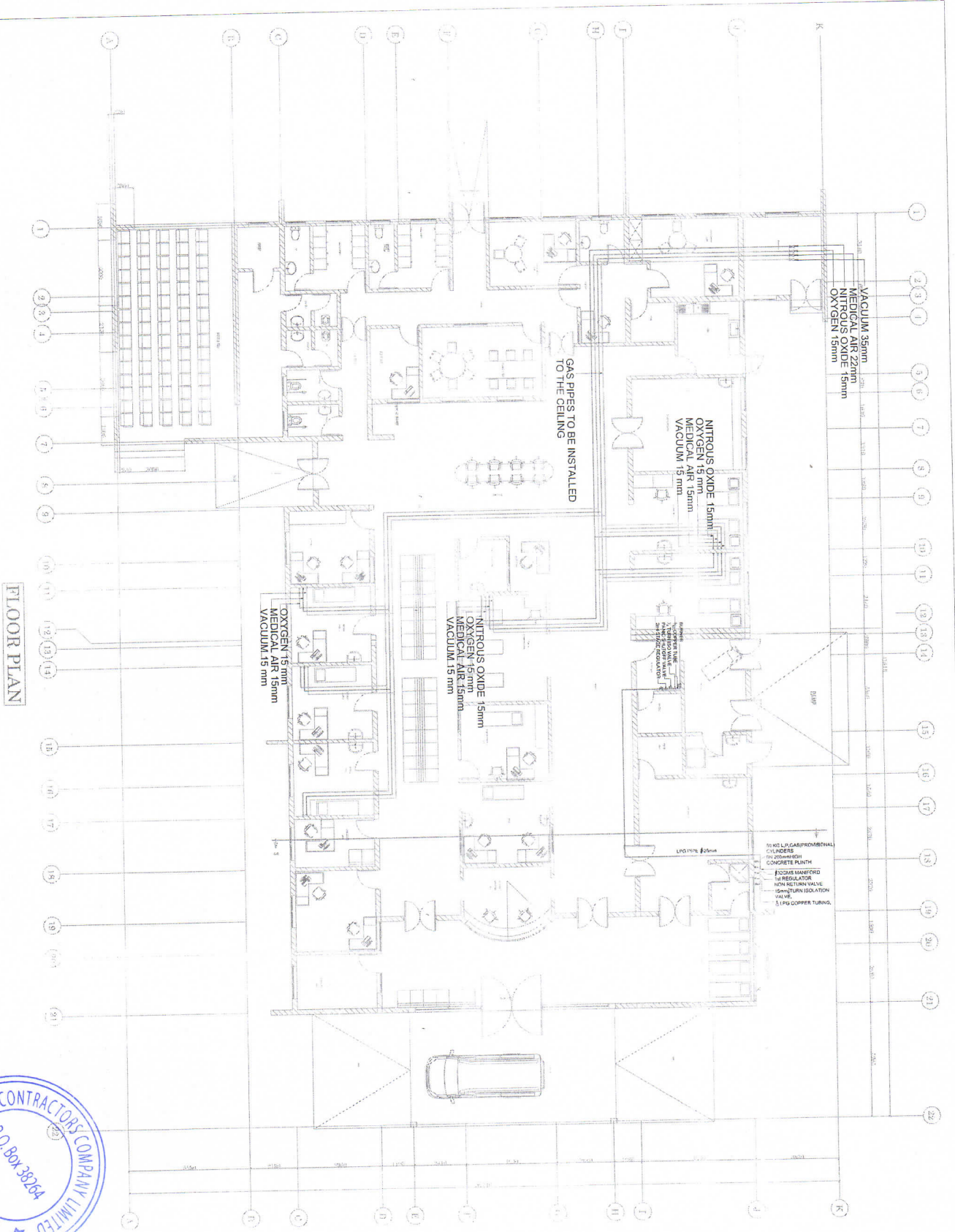

FLOOR PLAN



<p><b>NOTES:</b></p>	
<p><b>PROJECT:</b> PROPOSED CONSTRUCTION OF FBI AGENCY MEDICAL DEPARTMENT FOR GENERAL IBERRAHA HOSPITAL</p>	
<p><b>CLIENT:</b> MINISTRY OF HEALTH COMMUNITY DEVELOPMENT, GENDER, ELDERLY AND CHILDREN</p>	
<p><b>SERVICES DESIGNER:</b> PATRICIA D. S. E-mail : pdsthayo@gmail.com</p>	
<p><b>DRAWING TITLE:</b> GROUND FLOOR GAS INSTALLATION LAYOUT</p>	
<p>Scale: 1:100</p>	<p>Date: 15/05/2024</p>
<p>Drawn: Patricia D. S.</p>	<p>Checked: Patricia D. S.</p>
<p>Project: P-001</p>	<p>Client: Ministry of Health</p>
<p>Drawn by: MH/EMD/MS-02</p>	<p>Checked by: MH/EMD/MS-02</p>

# PLUMBING SERVICE LIST OF DRAWINGS

S/No.	DESCRIPTION	DRAWING No.	DATE/REV.
1	LIST OF DRAWINGS PLUMBING	MH/EMD/ME-PL/00	OCT, 2019
2	SYMBOLS, LEGEND & GENERAL NOTES & SCHEDULE OF EQUIPMENT	MH/EMD/ME-PL/01	OCT, 2019
3	WATER SUPPLY LAYOUT GROUND FLOOR PLAN	MH/EMD/ME-WS/02	OCT, 2019
4	WATER SUPPLY LAYOUT UNDERGROUND TANK DETAILS	MH/EMD/ME-WS/03	OCT, 2019
5	WASTE WATER LAYOUT GROUND FLOOR PLAN	MH/EMD/ME-WS/04	OCT, 2019
6	MANHOLE DETAILS	MH/EMD/ME-WS/05	OCT, 2019
7	SEPTIC TANK DETAILS	MH/EMD/ME-WS/06	OCT, 2019
8	SOAK AWAY PIT DETAILS	MH/EMD/ME-WS/07	OCT, 2019

NOTES:

REVISIONS:

**PROJECT:**  
PROPOSED CONSTRUCTION OF EMERGENCY MEDICAL DEPARTMENT (EMD) FOR GENERAL RIFERRAL HOSPITAL

**CLIENT:**  
MINISTRY OF HEALTH COMMUNITY DEVELOPMENT GENDER ELDERLY AND CHILDREN

**SERVICES DESIGNER:**  
PATRICIA D. S.  
E-mail : pdsteyo@gmail.com

**DRAWING TITLE:**

LIST OF DRAWINGS PLUMBING

Scale	Drawn	Checked	Approved
1:1			

Working Number: MH/EMD/ME-PL-00



42

**LEGEND**

- COLD WATER SUPPLY PIPE
- SOIL WATER DRAINAGE PIPE
- GRAY WATER DRAINAGE PIPE
- ⋈ STOP VALVE
- GT GULLY TRAP
- ⊗ FD/FG FLOOR DRAIN/FLOOR GULLY
- MH INSPECTION CHAMBER/MANHOLE (SOLID WASTE/WASTE WATER)
- + COLD WATER TAP
- N/— 'S' / 'P' WATER TRAP
- /— CLEANING EYE ON STACK PIPE AS SHOWN ON PLAN / ISOMETRIC WATER DIAGRAM
- H/W/B HAND WASH BASIN
- SS STAINLESS STEEL KITCHEN SINK
- WC WATER CLOSET
- WH WATER HEATER
- HS HANDS SPRAY
- SP SOIL WASTE PIPE
- W/P WASTE WATER PIPE

**NOTES**

**SOIL WATER DRAINAGE:**

- \* FOU WATER DRAINAGE AND SANITARY PIPEWORK SHALL BE IN ACCORDANCE WITH BS 5572
- \* WASTE/SOIL WATER AND VENT PIPES SHALL BE UPVC PIPES TO ISD/R/161 OR BS 4460/CLASS C. THE SIZES ARE INDICATED ON THE DRAWING.
- \* ALL BENDS AND TEES FOR VENT PIPES AND SULLAGE PIPES SHOULD HAVE ROBBING PROVISION BY WAY OF CLEANING EYE FOR INSPECTION.
- \* WHERE PIPES ARE CROSSING BELOW PAVED AREAS, PIPES SHALL BE SURROUNDED WITH 150mm CONCRETE GRADE IS.
- \* GENERAL SLOPE FOR EXTERNAL SOIL WATER PIPEWORK SHALL BE 1% AND 0.5% FOR WASTE WATER PIPEWORK.
- \* BEFORE CONSTRUCTION OF THE DRAINAGE SYSTEM THE GROUND LEVELS OF THE SITE HAVE TO BE CHECKED FOR CONFORMITY WITH THOSE SHOWN ON DRAWINGS.
- \* MANHOLE COVER LEVEL SHALL BE AS SUCH TO SUITE ADJACENT LEVELS, BUT SHALL ALWAYS BE 10 CM HIGHER THAN GROUND LEVEL.
- \* MANHOLE INVERT LEVELS REFERS TO +0.90 DATUM LEVEL OF THE GROUND FLOOR FINISH LEVEL.

**WATER SUPPLY**

- \* ALL INTERNAL WATER SUPPLY PIPES SHALL BE DIZAYN PP-R 80 SANITARY PIPES & FITTINGS GRADE TO BS 1387.
- \* EXTERNAL WATER SUPPLY PIPES SHALL BE DIZAYN PP-R 80 SANITARY PIPES & FITTINGS.
- \* WATER METER SHALL BE LOCATED UNDERGROUND IN A WATER METER CHAMBER WITH A REMOVABLE COVER
- \* TAPS AND VALVES SHALL BE COPPER ALLOY COMPLYING TO BS 5194 OR BS 1010. BALL VALVES SHALL BE IN ACCORDANCE WITH 1212.
- \* PIPES DIMENSIONS ARE IN MILLIMETERS NOMINAL DIAMETER.
- \* ALL INTERNAL WATER SUPPLY PIPES SHALL BE EMBEDDED IN WALLS OR FLOOR SLABS AS APPLICABLE OR ROOF LEVEL
- \* ALL WORKMANSHIP SHALL BE IN ACCORDANCE WITH BS 310.
- \* ALL PIPE CONNECTIONS TO TAPS AND SANITARY FITTINGS SHALL BE 15mm.
- \* SLEEVES HAS TO BE PROVIDED WHERE PIPES ARE CROSSING PAVED AREAS.
- \* WATER BOOSTER PUMPS:
  - TWO PUMPS SHALL BE INSTALLED. ONE SHALL BE DUTY AND THE OTHER SHALL BE STANDBY.
  - EACH PUMP SHALL HAVE A CAPACITY OF 36m<sup>3</sup> /hr AND 10m AVAILABLE HEAD.
  - THE PUMPS SHALL BE OF MAKE GRUNDFOS, OR SIMILAR APPROVED.
  - THE PUMPS TO SUPPLIED COMPLETE WITH CONTROL PANEL, STARTER, AND FLOAT SWITCHES.
  - THE OPERATION OF PUMPS SHOULD BE VIA FLOAT SWITCHES.
  - THIS WILL ALSO INCLUDE DRY RUNNING PROTECTION.

**NOTES:**

**PROJECT:**

PROPOSED CONSTRUCTION OF EMERGENCY WARD AT DEPARTMENT INTEND FOR GENERAL REFERRAL HOSPITAL.

**CLIENT:**

MINISTERS OF HEALTH COMMUNITY DEVELOPMENT (GENERAL LIBERITY AND CHILDREN).

**SERVICES DESIGNER:**

PATRICIA D. S.  
E-mail : pdshvvo@gmail.com

**DRAWING TITLE:**

LIST OF LEGEND SYMBOLS AND GENERAL NOTES



Scale:				
Date:				
Drawn by:				
Checked by:				
Project No:				
Sheet No:				



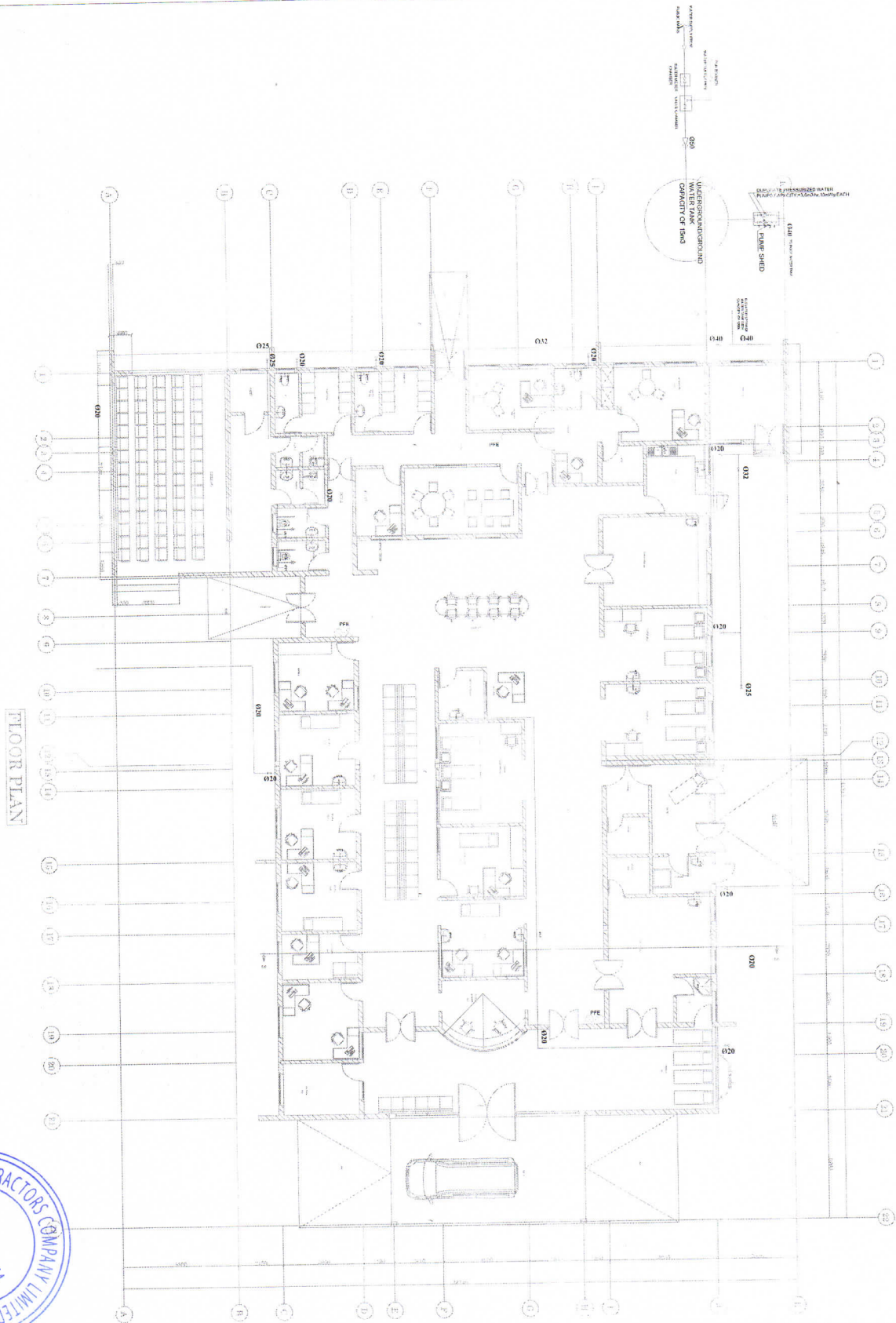

FLOOR PLAN

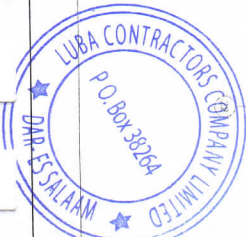

NOTES:

NO.	DATE	REVISIONS

**PROJECT:**  
 PROPOSED CONSTRUCTION OF EMERGENCY MEDICAL DEPARTMENT (EMD) FOR GENERAL REBRRAL HOSPITAL

**CLIENT:**  
 MINISTRY OF HEALTH COMMUNITY DEVELOPMENT GENDER ELDERLY AND CHILDREN

**SERVICES DESIGNER:**  
 PATRICIA D. S.  
 E-mail : psthayo@gmail.com

**DRAWING TITLE:**  
 GROUND FLOOR - WATER SUPPLY & FIRE FIGHTING LAYOUT

Scale:				
Author:				
Checker:				

MHEMD/EMS-02

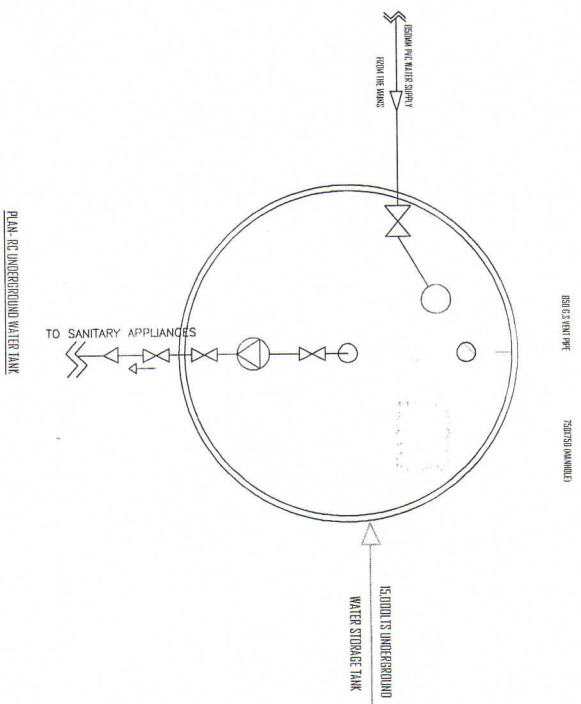

PLAN - RC UNDERGROUND WATER TANK

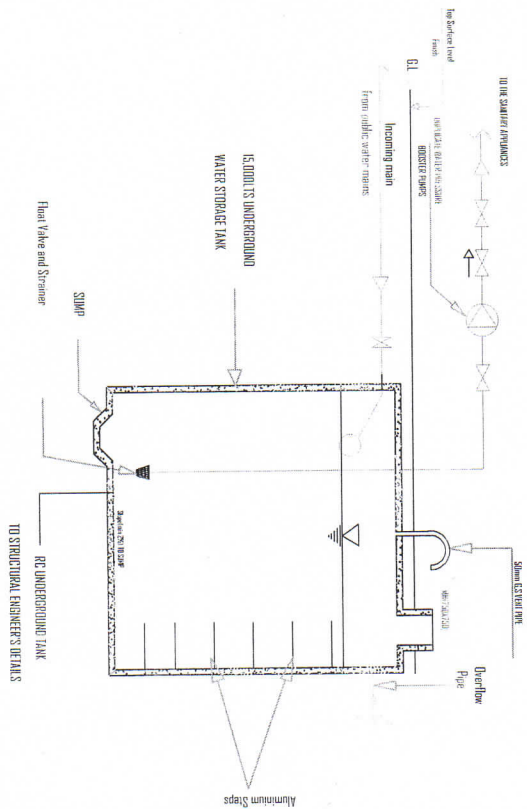

SECTION XX

NOTES:

NO.	DATE	REVISIONS

**PROJECT:**  
PROPOSED LAUNDRY FOR  
GENERAL REFERRAL HOSPITAL.

**CLIENT:**  
MINISTRY OF HEALTH COMMUNITY  
DEVELOPMENT (MSDC) ELDERLY  
AND CHILDREN.

**SERVICES DESIGNER:**  
PATRICIA D. S.  
E-mail : pdshayo@gmail.com

**DRAWING TITLE:**  
UNDERGROUND WATER STORAGE TANK  
DETAILS

Scale:	Under:	Plan:	Section:	Detail:
Drawn/Checked:				



AA

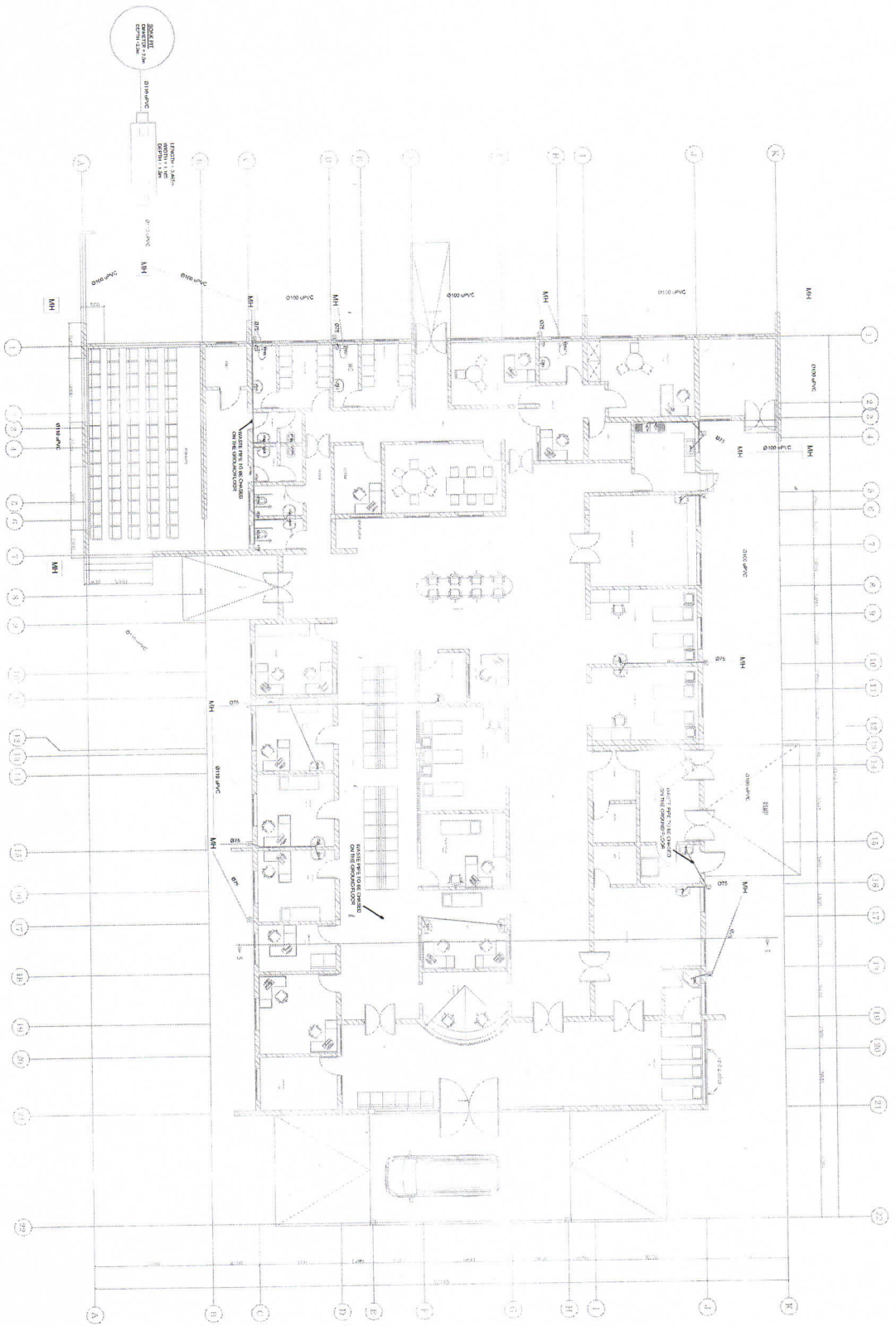

FLOOR PLAN

NOTES:

REVISIONS

**PROJECT:**  
 PROPOSED CONSTRUCTION OF EMERGENCY MEDICAL DEPARTMENT TENTED UNIT FOR GENERAL REFERRAL HOSPITAL

**CLIENT:**  
 MINISTRY OF HEALTH COMMUNITY DEVELOPMENT GENDER ELDERLY AND CHILDREN

**SERVICES DESIGNER:**  
 PATRICIA D. S.  
 E-mail : pdshayo@gmail.com

**DRAWING TITLE:**

GROUND FLOOR - WASTE WATER LAYOUT

DATE: / / DRAWN BY: CHECKED BY: APPROVED BY: CONSULTANT:

PROJECT NUMBER: MHEMDMEWV-04

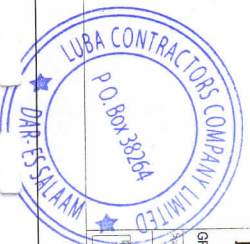

MASONRY BLOCKWORK OR IN SITU CONCRETE  
 MAXIMUM LESS THAN 1.1m TO GROUND PIPE

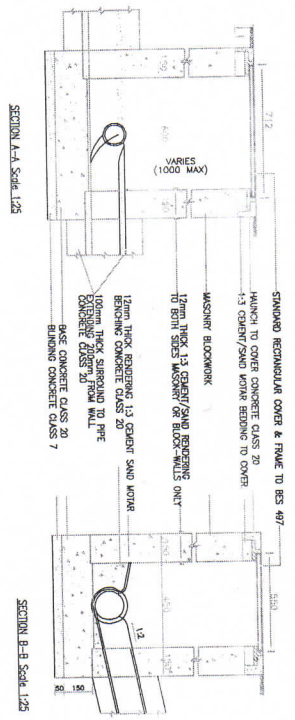

MASONRY BLOCKWORK OR IN SITU CONCRETE  
 MAXIMUM LESS THAN 2.0m TO GROUND PIPE

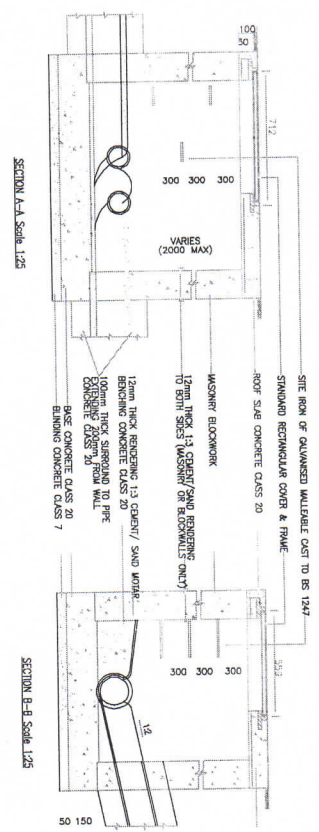

PLAN SHOWING SINGLE HOUSE CONNECTION Scale 1:25

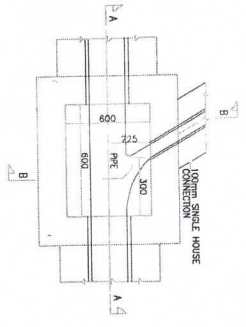

PLAN SHOWING ALTERNATIVE TWIN HOUSE CONNECTION Scale 1:25

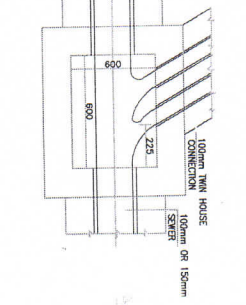

PLAN SHOWING ALTERNATIVE TWIN HOUSE CONNECTION Scale 1:25

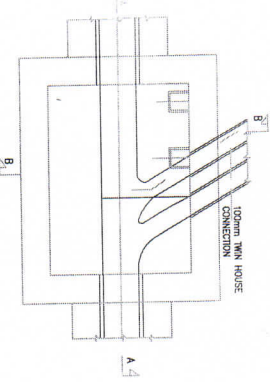

ROOF PLAN Scale 1:25

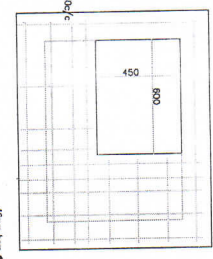

SHALE TILES - PLAN Scale 1:20

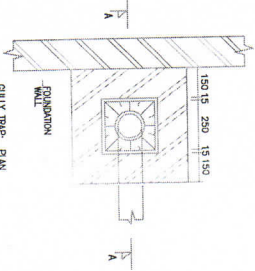

SECTION A-A Scale 1:20

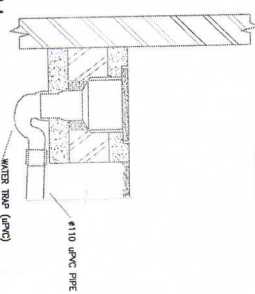

COVER DETAIL (300x300mm) Scale 1:10

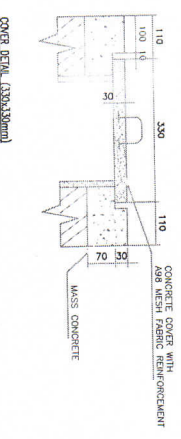

NOTES:

NO.	DATE	REVISION	BY	CHKD	APP'D

**PROJECT:**

PROPOSED CONSTRUCTION OF EMERGENCY MEDICAL DEPARTMENT (EMD) FOR GENERAL REBERRAL HOSPITAL

**CLIENT:**

MINISTRY OF HEALTH/COMMUNITY DEVELOPMENT/GENDER, ELDERLY AND CHILDREN

**SERVICES DESIGNER:**

PATRICIA D. S.  
 E-mail : pdshayo@gmail.com

**DRAWING TITLE:**

MANHOLE DETAILS

Author	Checked	Drawn	Scale
Patricia D. S.	Patricia D. S.	Patricia D. S.	As Shown
Project No.	Project Name	Project Location	Project Date
MHEMD/EMW-415			



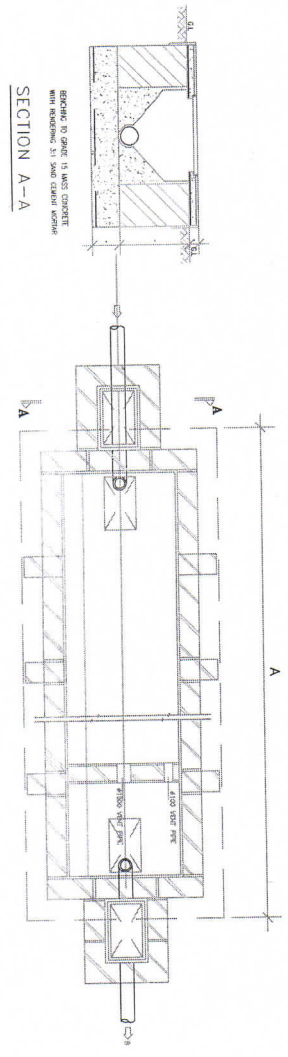

PLAN-SEPTIC TANK

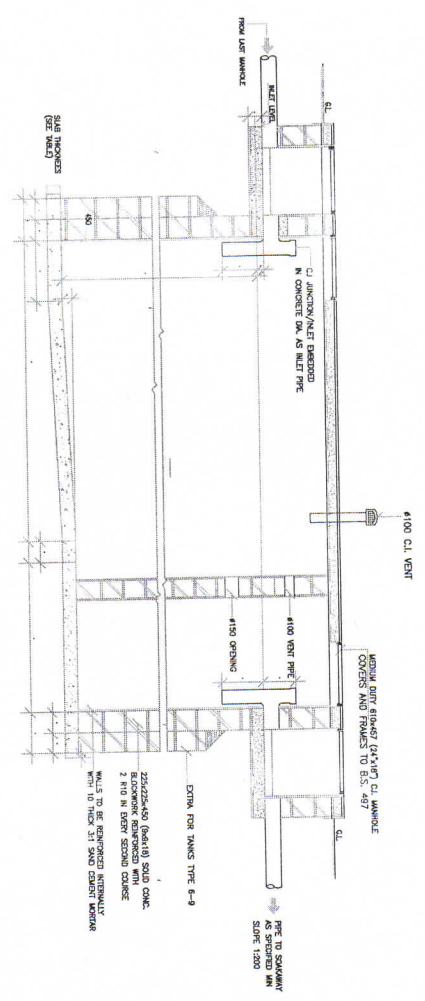

LONGITUDINAL SECTION

- NOTES**
1. ALL CONCRETE TO BE GRADE C20 UNLESS OTHERWISE STATED.
  2. ALL DIMENSIONS ARE IN MILLIMETRES UNLESS OTHERWISE SHOWN.
  3. BACKFILL MATERIAL TO BE APPROVED SAND/GRAVEL CAREFULLY RAMMED.

SEPTIC TANK SIZE

S. T. TYPE	LENGTH	WIDTH	DEPTH	BASE SLAB (FOUNDATION)		THICKNESS
				A	B	
1	2310	930	1500	3085	1930	150
2	2770	930	1500	3545	1930	150
3	2770	930	1800	3545	1930	150
4	3465	1165	1500	4240	2165	225
*5	3465	1165	1800	4240	2165	225
6	4150	1390	1500	5375	2390	225
7	4150	1390	1800	5375	2390	225
8	4840	1625	1800	6065	2625	225
9	5330	1850	1800	6755	2950	225

N.B. SEPTIC TANKS TYPE 6 - 9 HAVE SUPPORTS ON WIDTH AS INDICATED ON LONGITUDINAL SECTION

\* SEPTIC TANK TYPE NO.5 WILL BE USED.

NOTES:

NO.	DATE	REVISIONS

**PROJECT:**  
PROPOSED CONSTRUCTION OF EMERGENCY MEDICAL DEPARTMENT IN/IN/MD FOR GENERAL REFERRAL HOSPITAL

**CLIENT:**  
MINISTRY OF HEALTH, COMMUNITY DEVELOPMENT, GENDER, FETTERLITY AND CHILDREN.

**SERVICES DESIGNER:**  
PATRICIA D. S.  
E-mail : pdshayo@gmail.com

**DRAWING TITLE:**  
SEPTIC TANK DETAILS

SCALE	DATE	BY	CHECKED	APPROVED

PROJECT NO: MHEMD/MEMW/406



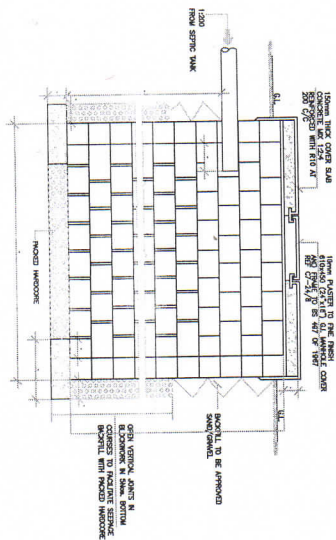

SECTION - SOAKAGE PIT

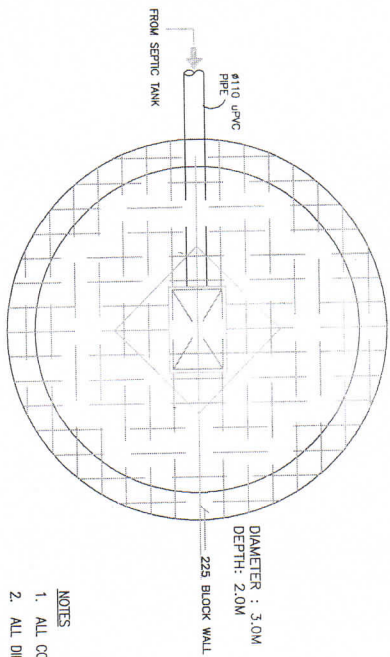

SOAKPIT PLAN

- NOTES
1. ALL CONCRETE TO BE GRADE C20 UNLESS OTHERWISE STATED.
  2. ALL DIMENSIONS ARE IN MILLIMETRES UNLESS OTHERWISE SHOWN.
  3. BACKFILL MATERIAL TO BE APPROVED SAND/GRAVEL CAREFULLY RAMMED.

LITRE		SOIL		4		9		16		100		36		49	
WASTES	No. of users	WASTES	No. of users	DA	DA	DA	DA	DA	DA	CUBIC M.	LITRES	DA	DA	DA	DA
1	10	8	20	2.30	1.70	1.30	2.60	2.60	2.60	2.60	2.60	2.60	2.60	2.60	2.60
15	30	4.5	30	1.70	1.40	1.40	3.30	3.30	3.30	3.30	3.30	3.30	3.30	3.30	3.30
40	60	3.0	60	1.20	1.20	1.20	5.10	5.10	5.10	5.10	5.10	5.10	5.10	5.10	5.10
50	75	2.5	75	1.00	1.00	1.00	7.02	7.02	7.02	7.02	7.02	7.02	7.02	7.02	7.02
75	105	2.0	105	0.80	0.80	0.80	9.10	9.10	9.10	9.10	9.10	9.10	9.10	9.10	9.10
85	120	1.80	120	0.70	0.70	0.70	12.28	12.28	12.28	12.28	12.28	12.28	12.28	12.28	12.28
							22.95	22.95	22.95	22.95	22.95	22.95	22.95	22.95	22.95
							26.00	26.00	26.00	26.00	26.00	26.00	26.00	26.00	26.00

NOTES:

REVISIONS

**PROJECT:**  
PROPOSED CONSTRUCTION OF EMERGENCY MEDICAL DEPARTMENT (EMD) FOR GENERAL REFERRAL HOSPITAL

**CLIENT:**  
MINISTRY OF HEALTH COMMUNITY DEVELOPMENT, GENDER, ELDERLY AND CHILDREN.

**SERVICES DESIGNER:**

PATRICIA D. S.  
E-mail : pdshayo@gmail.com

**DRAWING TITLE:**

SOAKAGE PIT DETAILS

Scale	Project	Client	Contract
As per	As per	As per	As per
As per	As per	As per	As per
As per	As per	As per	As per



PROPOSED CONSTRUCTION OF EMERGENCY MEDICAL DEPARTMENT (EMD) FOR REGIONAL REFERRAL HOSPITALS FOR MINISTRY OF HEALTH, COMMUNITY DEVELOPMENT, GENDER, ELDERLY AND CHILDREN

TYPICAL NOTES

1. The drawing should be read in conjunction with respective architectural drawing.
2. For discrepancy refer to Structural Engineer for reconciliation.
3. Concrete for R.C. work shall be Grade 25 in Footings and columns; 20 N/mm<sup>2</sup> for beams and slabs – Nominal volumetric proportion shall be 1:1.5:3 and 1:2: 4; respectively. cube strength not less than 25 N/mm<sup>2</sup> and 20 N/mm<sup>2</sup> within 28 days.
4. Reinforcement of plain round hot rolled mild steel with a minimum yield stress of 250 N/mm<sup>2</sup> shall be used for all links.
5. Reinforcement of hot rolled high tensile deformed steel bars with a minimum yield stress of 460 N/mm<sup>2</sup> shall be used for all main bar reinforcement.
6. Concrete for strip wall foundations to be grade 20 Nominal volumetric proportion 1:2:4 cube strength of not less than 20 N/mm<sup>2</sup> within 28 days.
7. A levelling course of 50mm thick with a concrete grade 10 of 1:4 :8 nominal volumetric proportion, shall be given under all column bases and strip footings.
8. Clear cover for concrete shall be as follows: -  
Slabs and walls .....20 mm.  
Beams .....25 mm for main reinforcement.  
Columns.....30 mm for links.  
Foundations.....50 mm.
9. Concrete blocks used for load bearing walls shall be of concrete grade 10 with cube strength not less than 10 N/ mm<sup>2</sup> on cement -sand mortar. All blocks used for load bearing walls must be cured for 28 days.
10. Concrete blocks used for other than load bearing walls can be of concrete grade 7. Nominal volumetric proportion of 1:4:8 with cube strength of not less than 28 days, on cement – lime , sand mortar of 1:3:6 by volume. All blocks used for block work must be at least 28 days.
11. Timber used for structures to be podo or mlambara or cypress or cedar- seasoned with moisture below 18%, in case of use of other kinds of timber than the Structural Engineer's approval is required.
12. Timber used for structures to be treated with pressure impregnation.
13. The depth of setting foundations depends on the site conditions and may be adjusted according to Structural Engineer 's instructions.
14. Material for hardcore should either be Hard stone or coral stone sizes varying from 100 mm to 40mm.
15. Material for aggregate shall be granite supplied from any other source as approved by Engineer Sizes to be 12.5 mm for columns, slabs, beams and staircase. 19.0mm for Foundations.



PROPOSED CONSTRUCTION OF EMERGENCY MEDICAL DEPARTMENT (EMD) FOR REGIONAL REFERRAL HOSPITALS FOR MINISTRY OF HEALTH, COMMUNITY DEVELOPMENT, GENDER, ELDERLY AND CHILDREN

**LIST OF STRUCTURAL DRAWINGS**

01. FOUNDATION LAYOUT PLAN .....	S01/12
02. GROUND FLOOR PLAN .....	S02/12
03. LOER ROOF PLAN .....	S03/12
04. UPPER ROOF PLAN .....	S04/12
05. COLUMN FOOTINGS AND COLUMNS RC DETAILS .....	S05/12
06. ROOF SLAB R.C DETAILS BOTTOM AND TOP BARS .....	S06/12
07. LOWER TRUSS ELEVATIONS .....	S07/12
08. TRUSS ELEVATIONS .....	S08/12
09. UPPER ROOF TRUSS AND CONNECTION DETAILS .....	S09/12





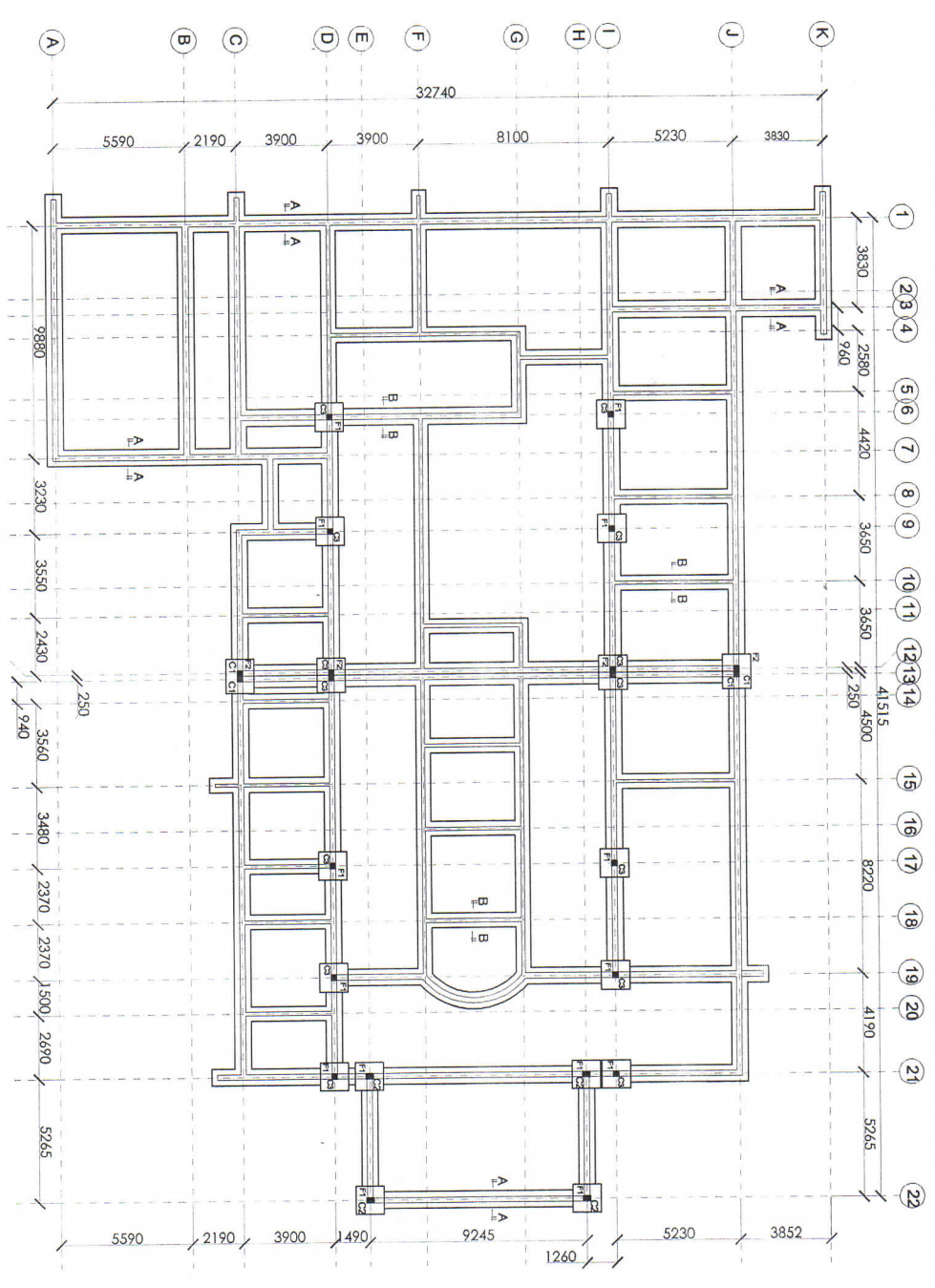

FOUNDATION LAYOUT PLAN  
SCALE 1:200

1. General Notes:  
THIS DRAWING SHALL BE USED IN CONNECTION WITH THE CONTRACT AND SERVICE ENGINEERING DRAWINGS.

No.	Revision/Issue	Date	Job No.
			CF/END/MB/19

Client: MINISTER OF HEALTH, COMMUNITY DEVELOPMENT, GENDER, ELDERLY AND CHILDREN  
Project: PROPOSED CONSTRUCTION OF EMERGENCY MEDICAL DEPARTMENT (EMD) FOR REGIONAL REFERRAL HOSPITAL

Drawing Title: FOUNDATION PLAN AND SECTIONS

Design By:	Checked By:	Date:	Approved By:
FONG CA ZS	M. AWANUKA	12/09/13	
		04/01/19	

FOOTING SCHEDULES		
TYPE	FOOTING SIZE	NO
F1	1200X1200X350	14
F2	1200X1450X350	4

COLUMN SCHEDULES		
TYPE	COLUMN SIZE	NO
C1	230x230mm	4
C2	230x300mm	4
C3	230x230mm	10

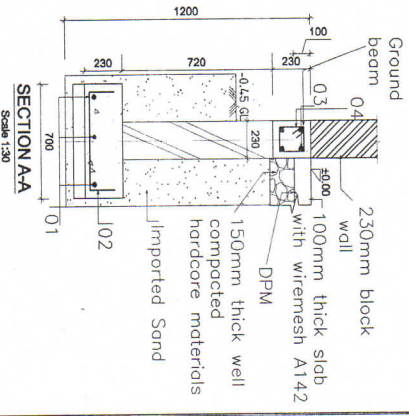

R8-04-200 x4Y16-03,  
L=900 L=12000

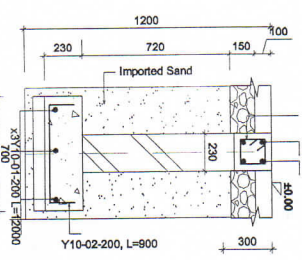

SECTION B-B  
Scale 1:50



AP

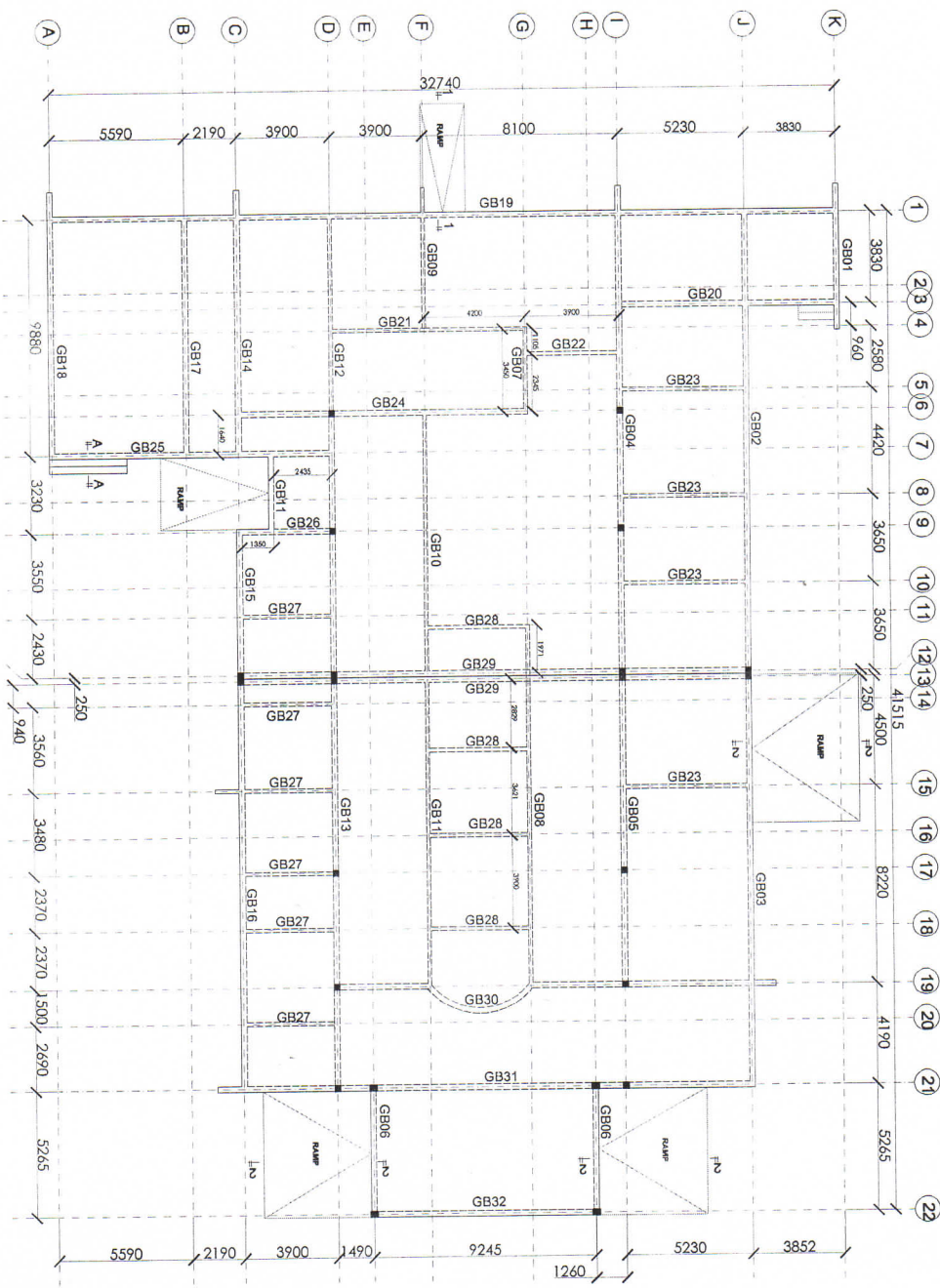

GROUND FLOOR LAYOUT PLAN  
SCALE 1:200

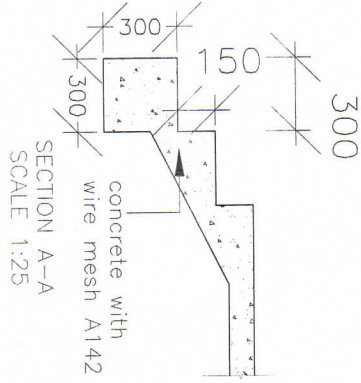
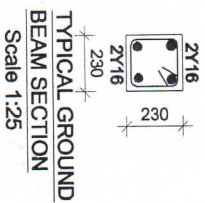
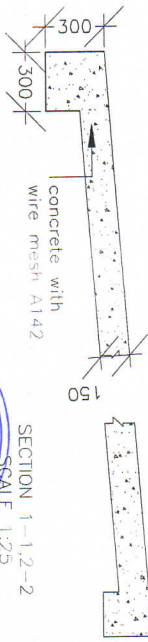

1. General Notes:  
THIS DRAWING SHALL BE USED IN CONNECTION WITH THE CONTRACT AND SERVICE ENGINEERING DRAWINGS

No.	Revision/Issue	Date	Job No.
			CF/EPD/04/19

Client: MINISTRY OF HEALTH, COMMUNITY DEVELOPMENT, GENDER, ELDERLY AND CHILDREN  
Project: PROPOSED CONSTRUCTION OF EMERGENCY MEDICAL DEPARTMENT (EMD) FOR REGIONAL GENERAL HOSPITAL

Drawing Title: GROUND FLOOR PLAN AND SECTIONS

Designed by:	Checked by:	Scale:	Date:	Approved by:	Dwg No:
FORUG Z/S	A. WIGOTVA	1:200, 1:25	OCT 2019	M. MAMUNUKA	507/12



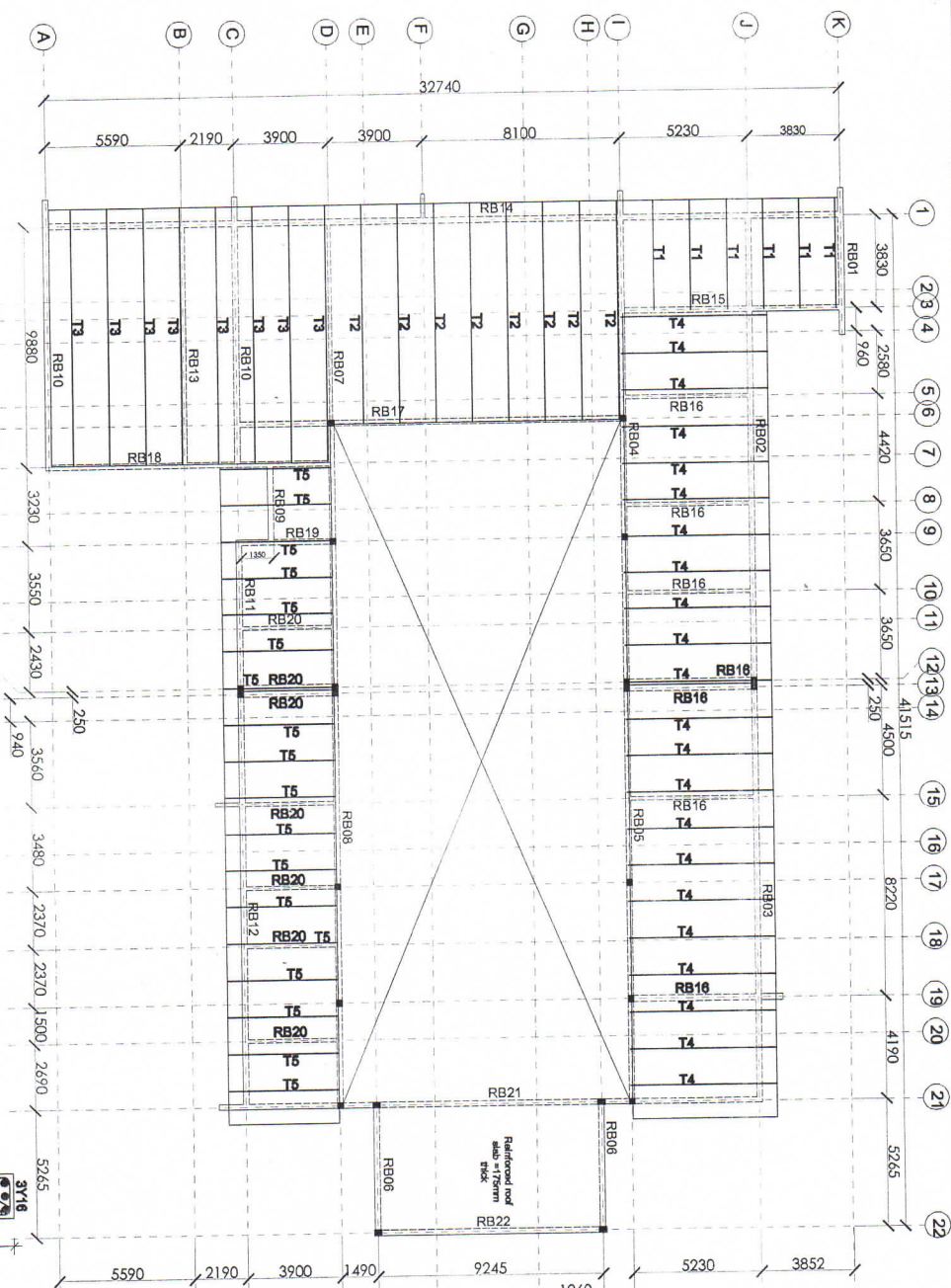

LOWER ROOF LAYOUT PLAN  
SCALE 1:200

TYPICAL ROOF BEAM SECTION  
Scale 1:25

ROOF BEAM RB21/22 BEAM SECTION  
Scale 1:25

ROOF BEAMS SCHEDULE LOWER LEVEL		
TYPE	BEAM SIZE	NO
RB01	230X300	1
RB02	230X300	1
RB03	230X300	1
RB04	230X300	1
RB05	230X300	1
RB06	230X300	1
RB07	230X300	1
RB08	230X300	1
RB09	230X300	1
RB10	230X300	1
RB11	230X300	1
RB12	230X300	1
RB13	230X300	1
RB14	230X300	1
RB15	230X300	1
RB17	230X300	1
RB18	230X300	1
RB19	230X300	1
RB20	230X300	1
RB21	230X650	1
RB22	230X650	1

SCALE:1:25

1. General Notes:  
THIS DRAWING SHALL BE READ IN CONJUNCTION WITH ARCHITECTURAL AND SERVICE ENGINEERING DRAWINGS

No.	Revised/Issue	Date	Job No.
			CF/END/M4/19

Client: MINISTRY OF HEALTH, COMMUNITY DEVELOPMENT, GENDER, ELDERLY AND CHILDREN  
Project: PROPOSED CONSTRUCTION OF EMERGENCY MEDICAL DEPARTMENT (EMD) FOR REGIONAL GENERAL HOSPITAL

Drawing Title	Designed by	Checked by	Scale	Date	Approved by
LOWER ROOF LAYOUT PLAN	FONG QIA ZH	A. MOKHTA	1:200 1:25	OCT 2019	M. MAMUNUKA
					Dwg No: 509312



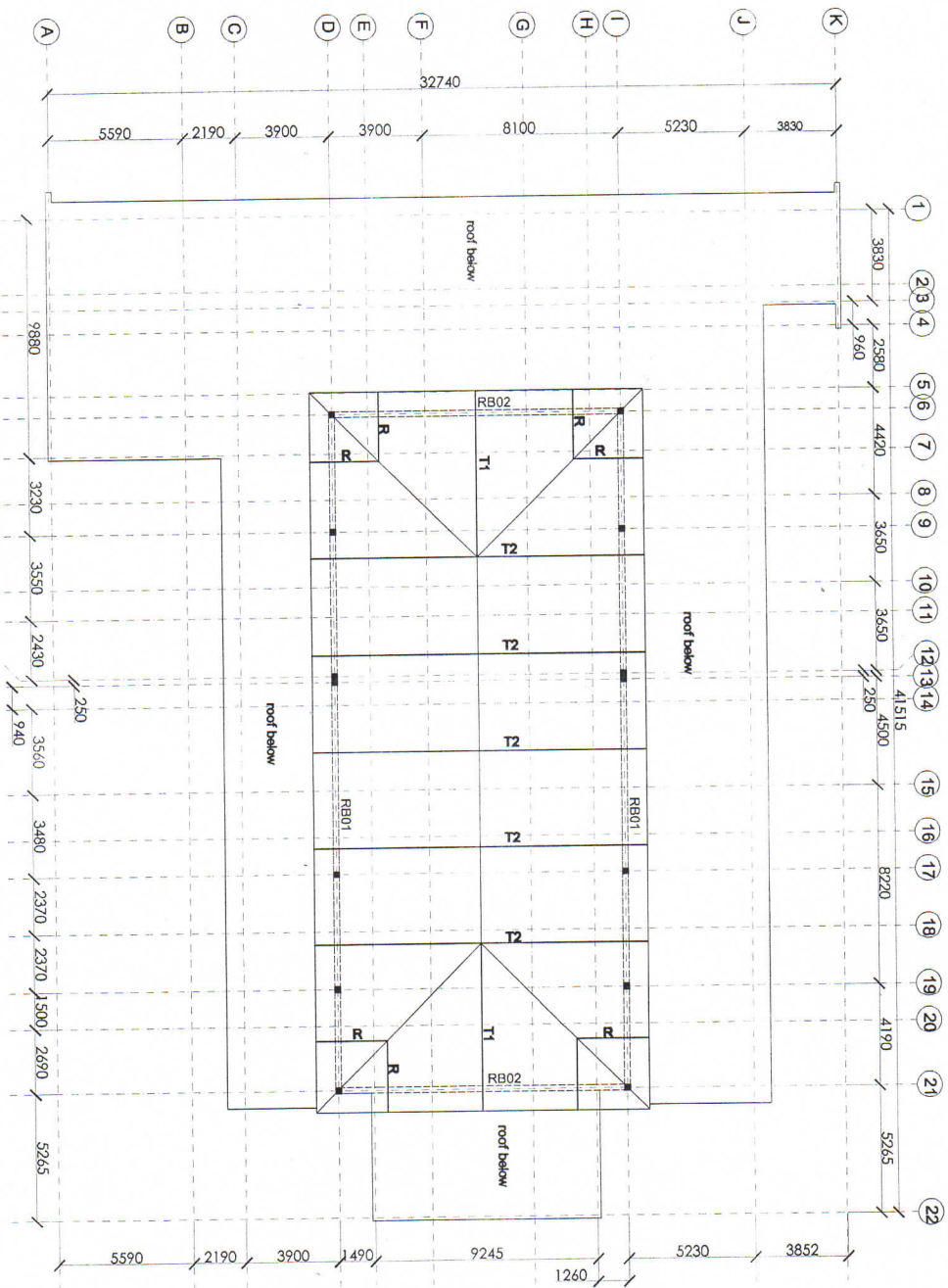

UPPER ROOF LAYOUT PLAN  
SCALE 1:200

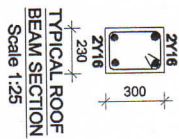

I. General Notes: THIS DRAWING SHALL BE READ IN CONJUNCTION WITH THE ENGINEERING DRAWINGS	No.	Revision/Issue	Date	Job No. CP/EMD/Med/19	Client: MINISTRY OF HEALTH, COMMUNITY DEVELOPMENT, GENDER, ELDERLY AND CHILDREN PROJECT: PROPOSED CONSTRUCTION OF EMERGENCY MEDICAL DEPARTMENT (EMD) FOR REGIONAL HERBAL HOSPITAL	Drawing Title: UPPER ROOF LAYOUT PLAN	Designed By: FADICA Z.S. Drawn By: FONGA Z.S. Checked By: A. MORTA Scale: 1:200 1:25 Date: OCT 2019	Approved By: M. MWINJUKA Dng No: 59412



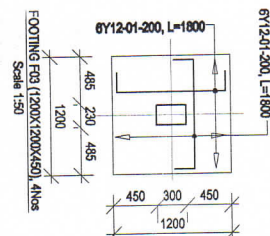
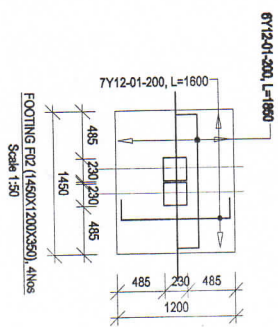
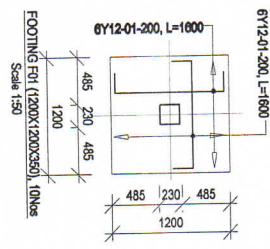
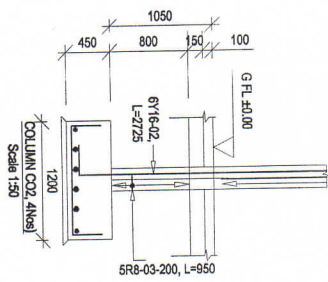
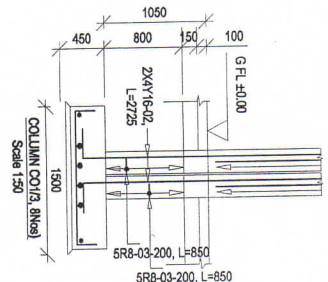
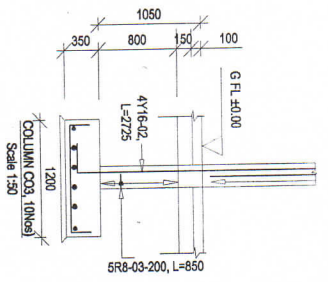
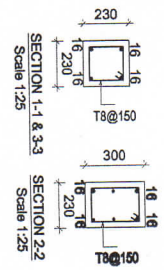
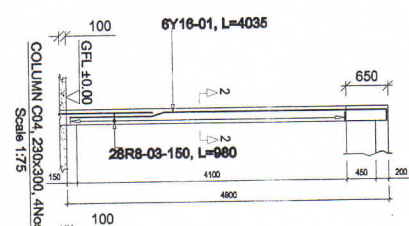
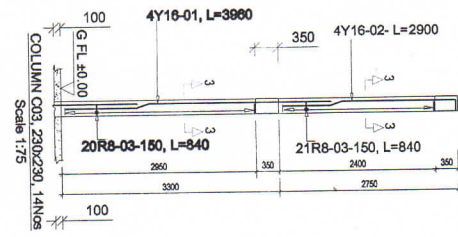
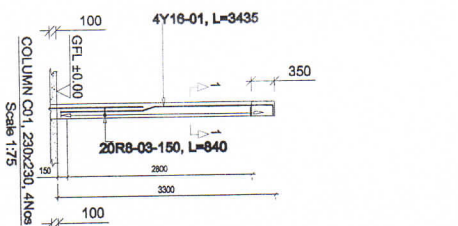

**General Notes:**

No.	Revision/Issue	Date	Job No:	Client:	Drawing Title:
			CF/END/MH/19	MINISTRY OF HEALTH, COMMUNITY DEVELOPMENT, GENDER, ELDERLY AND CHILDREN	COLUMNS AND FOOTINGS RC DETAILS
				PROPOSED CONSTRUCTION OF EMERGENCY MEDICAL DEPARTMENT (EMD) FOR REGIONAL REFERRAL HOSPITAL	

Designed by:	MUSFA CH	Approved by:	MUSFA CH
Checked by:	A. HADITHA	Drawn by:	MUSFA CH
Date:	OCT 2018	Scale:	1:50
		Proj No:	506/12



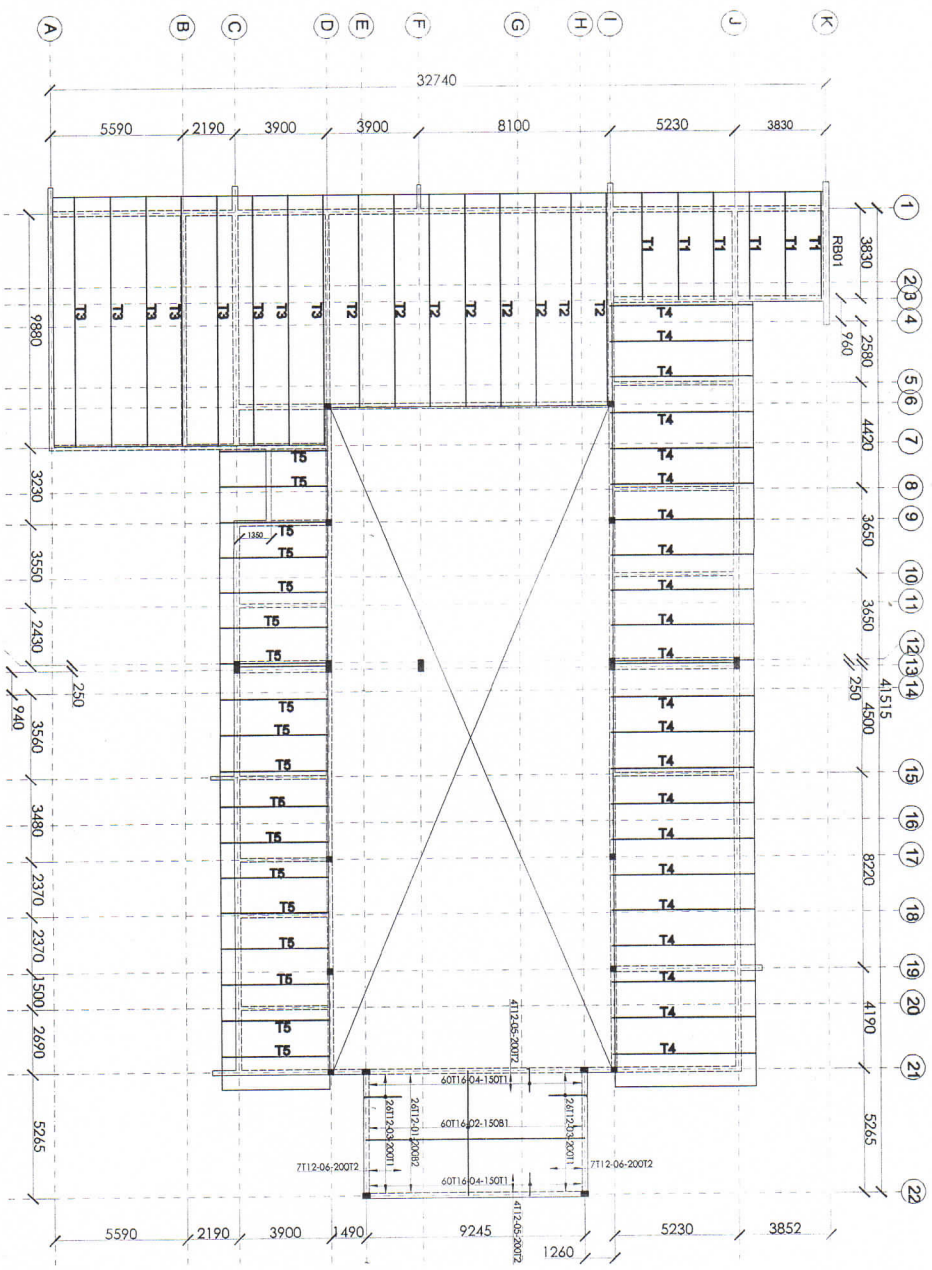

TYPICAL ROOF BEAM SECTION  
Scale 1:25

<p>General Notes: 1. THIS DRAWING SHALL BE READ IN CONJUNCTION WITH ARCHITECTURAL AND SERVICE ENGINEERING DRAWINGS</p>		<p>No. Revision/Issue</p>		<p>Date</p>		<p>Job No. GE/PHD/MH/19</p>		<p>Client: MINISTRY OF HEALTH, COMMUNITY DEVELOPMENT, GENDER, ELDERLY AND CHILDREN Project: PROPOSED CONSTRUCTION OF EMERGENCY MEDICAL DEPARTMENT (EMD) FOR RESIDUAL REFERRAL HOSPITAL</p>		<p>Drawing Title: ROOF SLAB RC DETAILS BOTTOM AND TOP BARS</p>	
<p>Designed by: FONGGA Z.S. Drawn by: A. IKOTTA Checked by: M. MANDUKA Scale: P:1:200 I:25 Date: OCT 2019</p>		<p>Approved by: [Signature]</p>		<p>Date: 2019</p>		<p>Job No. GE/PHD/MH/19</p>		<p>Client: MINISTRY OF HEALTH, COMMUNITY DEVELOPMENT, GENDER, ELDERLY AND CHILDREN Project: PROPOSED CONSTRUCTION OF EMERGENCY MEDICAL DEPARTMENT (EMD) FOR RESIDUAL REFERRAL HOSPITAL</p>		<p>Drawing Title: ROOF SLAB RC DETAILS BOTTOM AND TOP BARS</p>	



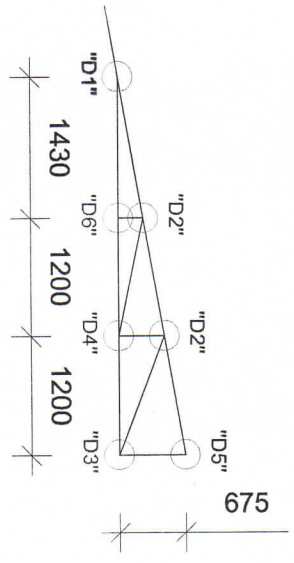

ROOF TRUSS ELEVATION T1(6)

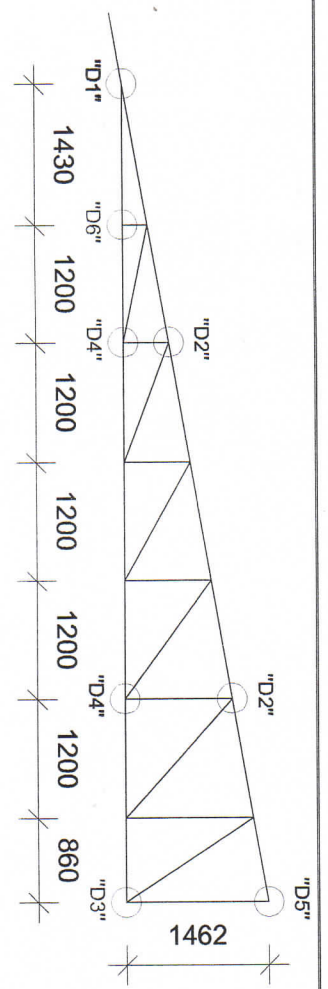

ROOF TRUSS ELEVATION T2(8)

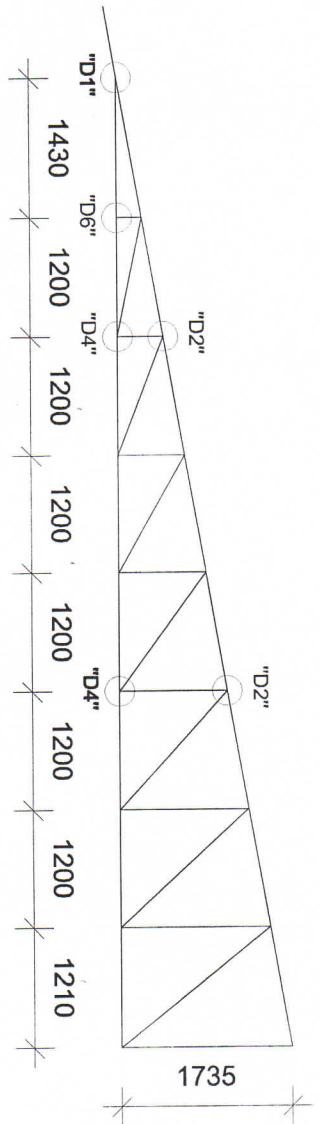

ROOF TRUSS ELEVATION T3(8)

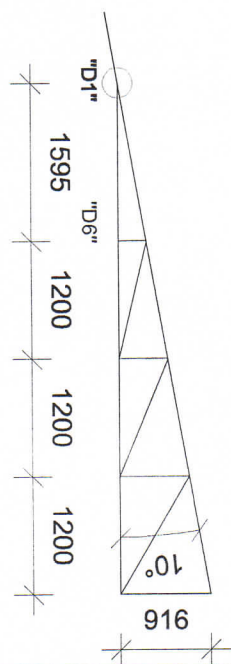

ROOF TRUSS ELEVATION T4(22)

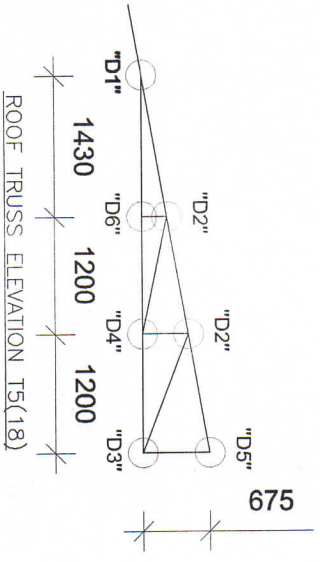

ROOF TRUSS ELEVATION T5(18)

General Notes:		No.	Revision/Issue	Date	Job No: CHBDM/MH/19	Client:	Drawing Title:	Designer:	Approved by:
						MINISTRY OF HEALTH, COMMUNITY DEVELOPMENT, GENDER, ELDERLY AND CHILDREN	LOWER ROOF TRUSS ELEVATIONS	MISBA, CH	MISBA, CH
						PROPOSED CONSTRUCTION OF EMERGENCY MEDICAL DEPARTMENT (EMD) FOR REGIONAL REFERRAL HOSPITAL		Checked by: D. KHORRAM	D. KHORRAM
								Scale: 1:50	100
								Date: OCT 2019	50/12

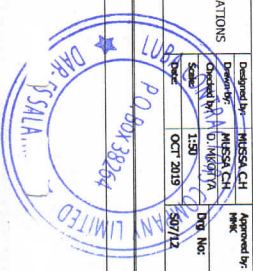

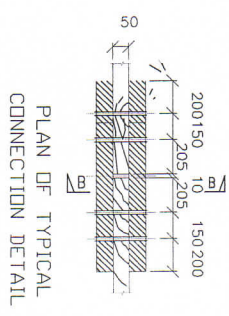
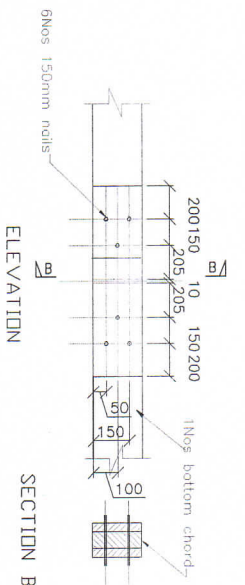
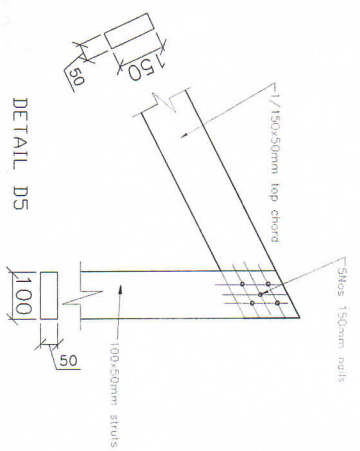
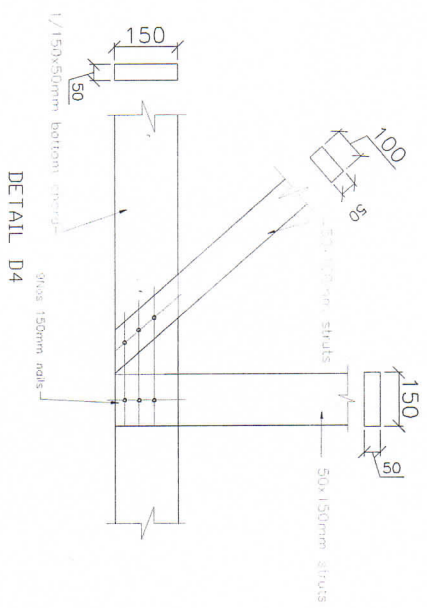
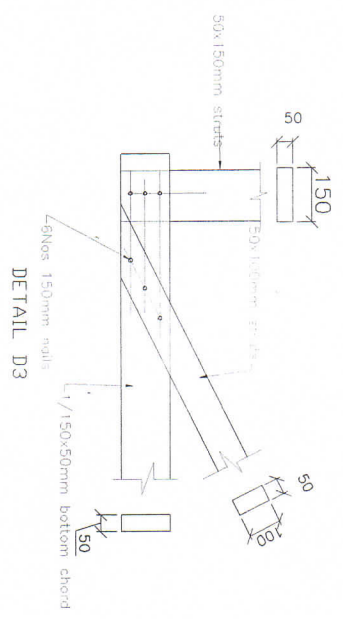
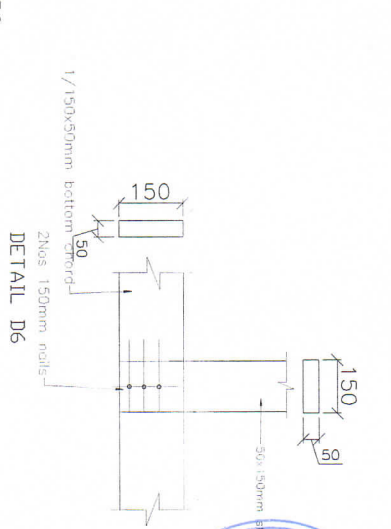
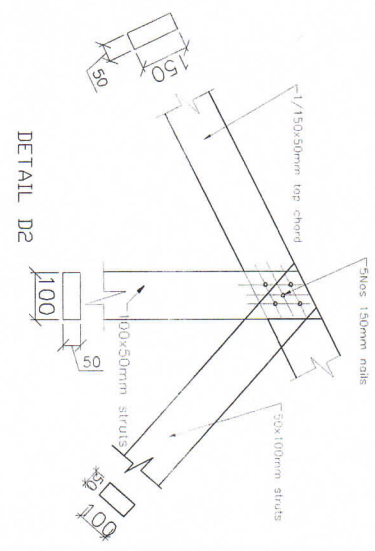
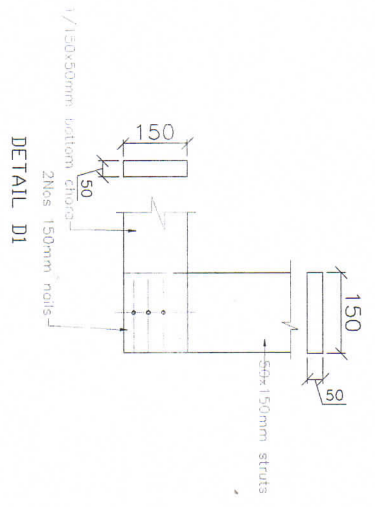

**General Notes:**

No.	Revision/Issue	Date	Job No:	Client:	Drawing Title:	Designed by:	Approved by:
			CFB/MW/19	MINISTRY OF HEALTH, COMMUNITY DEVELOPMENT, SENIORS, ADULTS AND CHILDREN	ROOF TRUSS CONNECTION DETAILS	MARSA CH	
				PROPOSED CONSTRUCTION OF EMERGENCY MEDICAL DEPARTMENT (EMD) FOR REGIONAL REFERRAL HOSPITAL		Checked by: DJ/MS/2019	Approved by: [Signature]
						Date: OCT 2019	Proj No: [Blank]

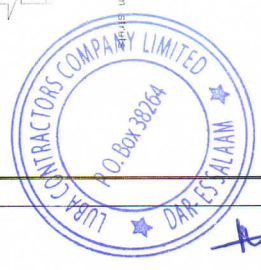



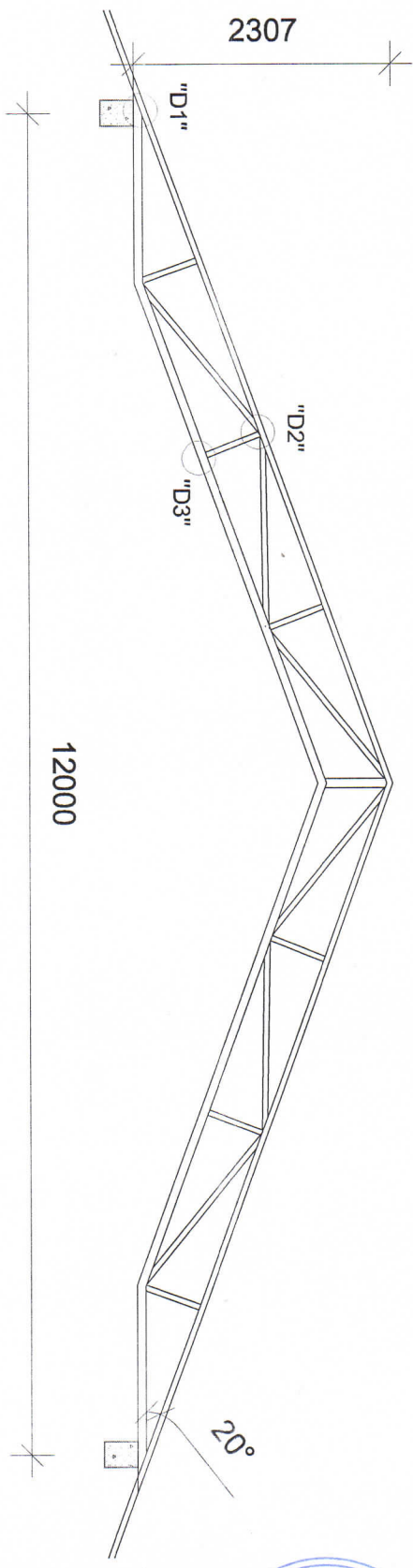

UPPER ROOF TRUSS ELEVATION T2(5)

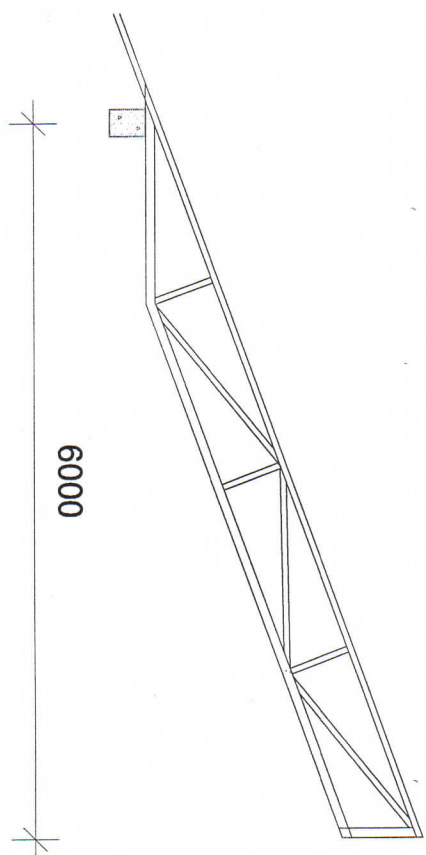

UPPER ROOF TRUSS ELEVATION T2(5)

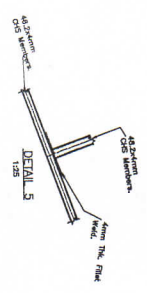
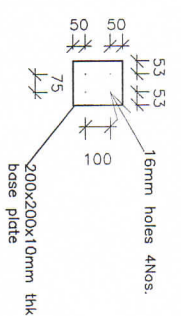
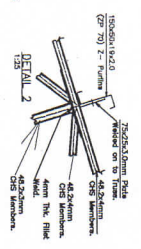
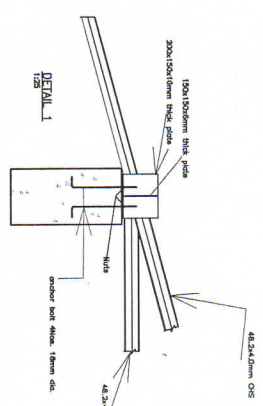

General Notes:		Job No: CF9ND/M4/19		Client: MINISTRY OF HEALTH, COMMUNITY DEVELOPMENT, GENDER, ELDERLY AND CHILDREN		Project: PROPOSED CONSTRUCTION OF EMERGENCY MEDICAL DEPARTMENT (EMD) FOR REGIONAL REFERRAL HOSPITAL		Drawing Title: UPPER ROOF TRUSS ELEVATIONS		Designed by: IZKHAZALI S		Approved by: IZKHAZALI S	
No.	Revision/Issue	Date											



AK

**ANY OTHER DOCUMENTS**

## 1.0 INTRODUCTION

The Government has received a loan from the International Monetary Fund towards the cost of **Implementation of National Development Project and Struggle against Covid- 19** for the operation of the Singida Regional Referral Hospital during the Financial year 2021/2022 . It is intended that part of the proceeds of the funds to be used to cover eligible payment under the contract for **Tender No. ME/007/SRRH/2021/2022/W/2** for **Proposed Construction of a Building of Emergency Medical Department (EMD) Block**

## 2.0 INVITATION FOR TENDER

The Singida Regional Referral Hospital Tender Board during ordinary meeting of 2021/2022 held on 12<sup>nd</sup> November, 2021 approved Single Source Procurement Method and bidding document for Tender No. ME/007/SRRH/2021/2022 for **Proposed Construction of a Building of Emergency Medical Department (EMD) Block**

## 3.0 OPENING

The deadline for the submission of the tender document was on 1<sup>st</sup> December ,2021 at 10:00 local time.

### 6.1.3 Eligibility:

Bids were checked to ensure;

- That the Tenders are from eligible source Countries.
- Submitted relevant Legal Document ie Business Licence, Certificate of Incorporation, and Certificate of Registration for TIN and VAT ITB 1.2,1.3

**Table 1: Identification**

1.1 Closing date (a) original (b) revised	1/12/2021 N/A
1.2 Name of project	<b>PROPOSED CONSTRUCTION OF EMERGENCY MEDICAL DEPARTMENT (EMD) BLOCK</b>
1.3 Purchaser (or Employer) (a) name (b) address	
1.4 Contract number (identification)	ME/007/SRRH/2021/2022/W/2
1.5 Contract description	<b>PROPOSED CONSTRUCTION OF EMERGENCY MEDICAL DEPARTMENT (EMD) BLOCK</b>
1.6 Source of funds	INTERNATIONAL MONETARY FUND ( IFM)
1.7 Method of procurement (check one)	<b>SINGLE SOURCE</b>
1.8 Preference allowed	No
1.9 If preference is not allowed, state reasons	N/A
1.9 Fixed price contract	Yes
1.10 Co-financing, if any: (a) agency name (b) percent financed by agency	N/A N/A